

21 OCTOBER 2020

FLETCHER STUDIO



INSPIRATION IN PUBLIC PRACTICE

SAN LUIS OBISPO

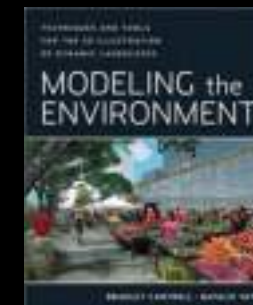

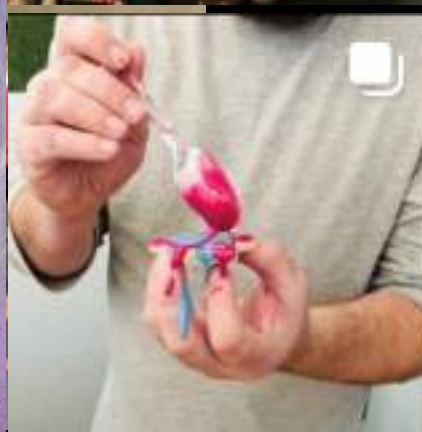

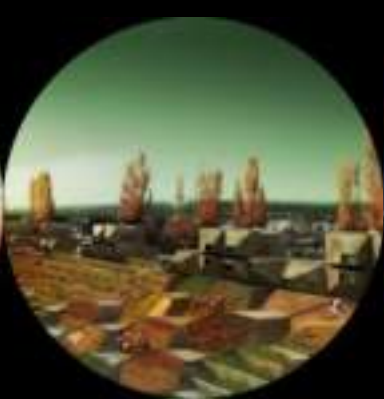
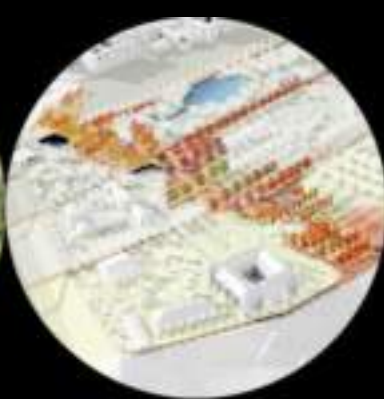
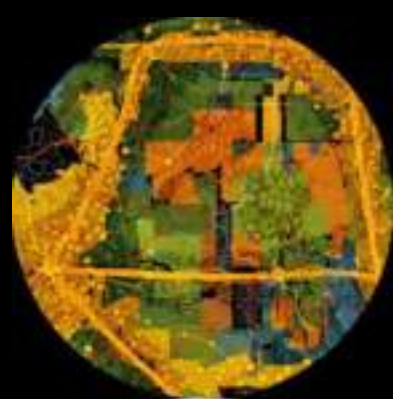

!

?

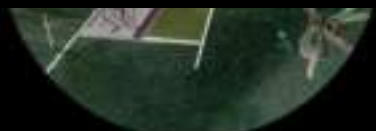
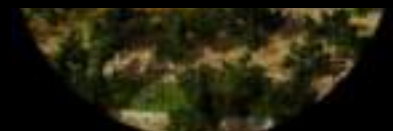



XL

L



M

S

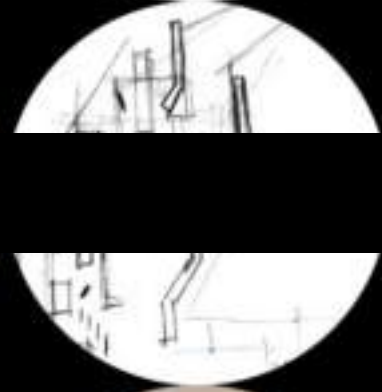
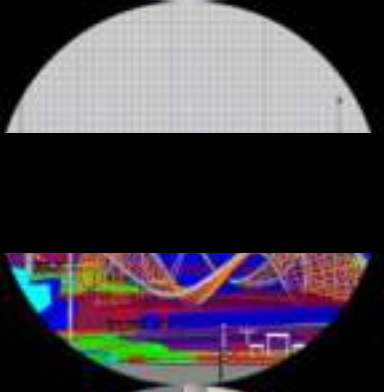
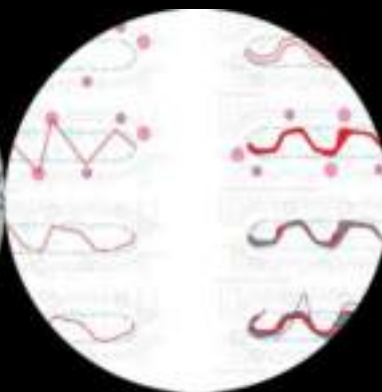
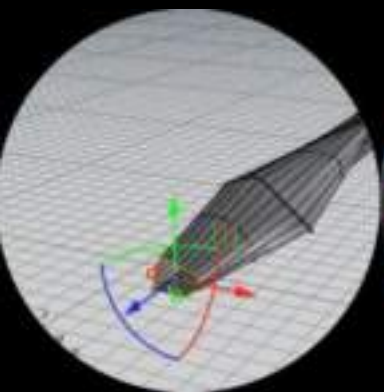

@

C

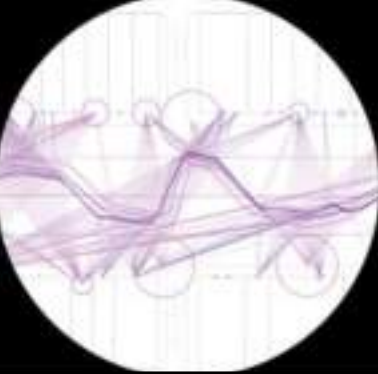
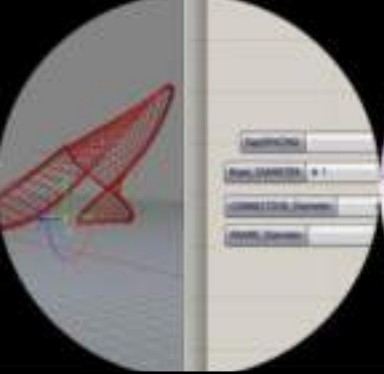



RIVERMARK, WEST SACRAMENTO



AGRARIAN LANDSCAPE + VIDEO GAME



GHOST CREEK + STRING OF PEARLS



DOGPATCH ARTWALK, SAN FRANCISCO



KUBRICK + OUTDOOR GALLERY





SEASONS + INVERSION





PAPER AIRPLANE+ PUBLIC PARKLET



GARDEN,



HERITAGE ROSE + PUBLIC PARK



STOP

6

AFFORDABLE HOUSING, SUNNYVALE



INTEGRATE + DAZZLE



THE PASSAGE : MULTI-FAMILY HOUSING, SAN MATEO



THE BEATLES + US GEOGRAPHY



MULTI-FAMILY HOUSING, BOZEMAN, MONTANA



MACRO + MICRO CONTEXTUALISM





PROGRAMMATIC MANIFOLD + PERIMETER



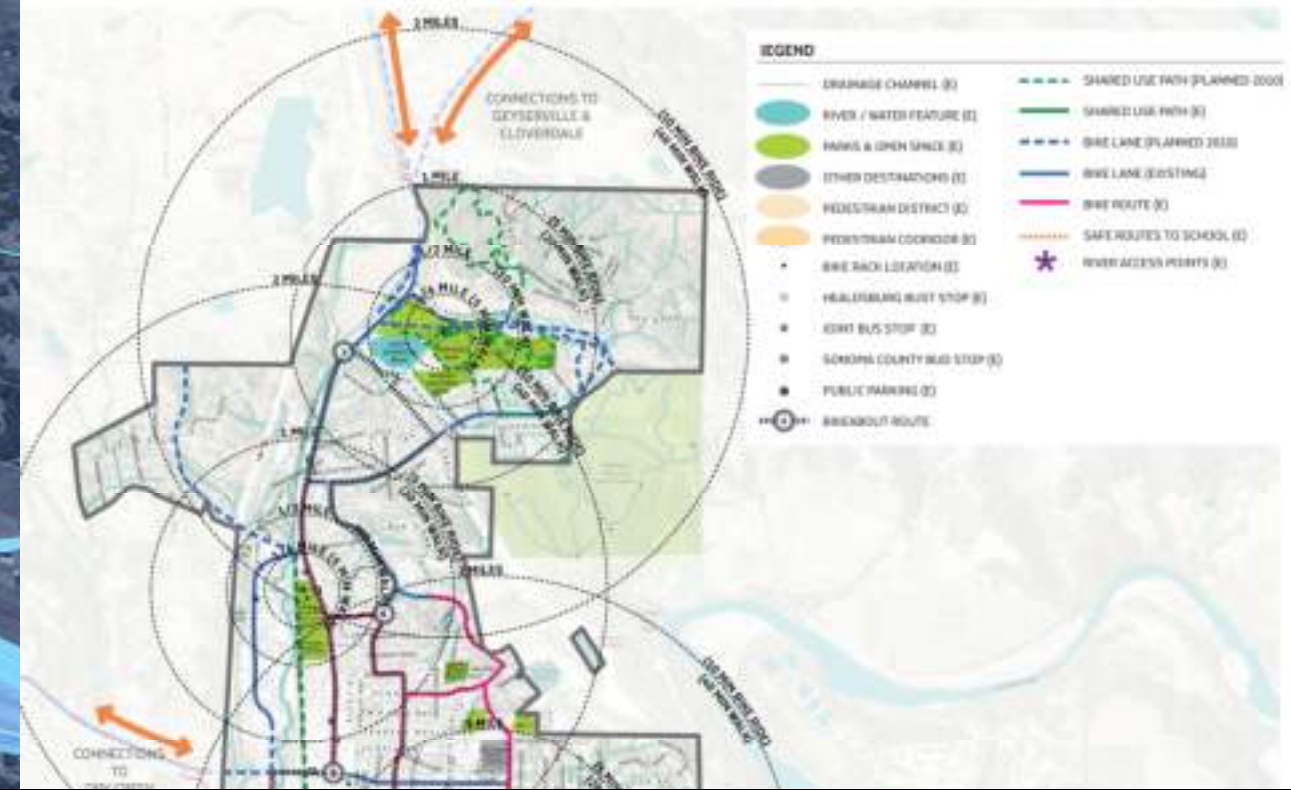

MOVEMENT + ACCESS

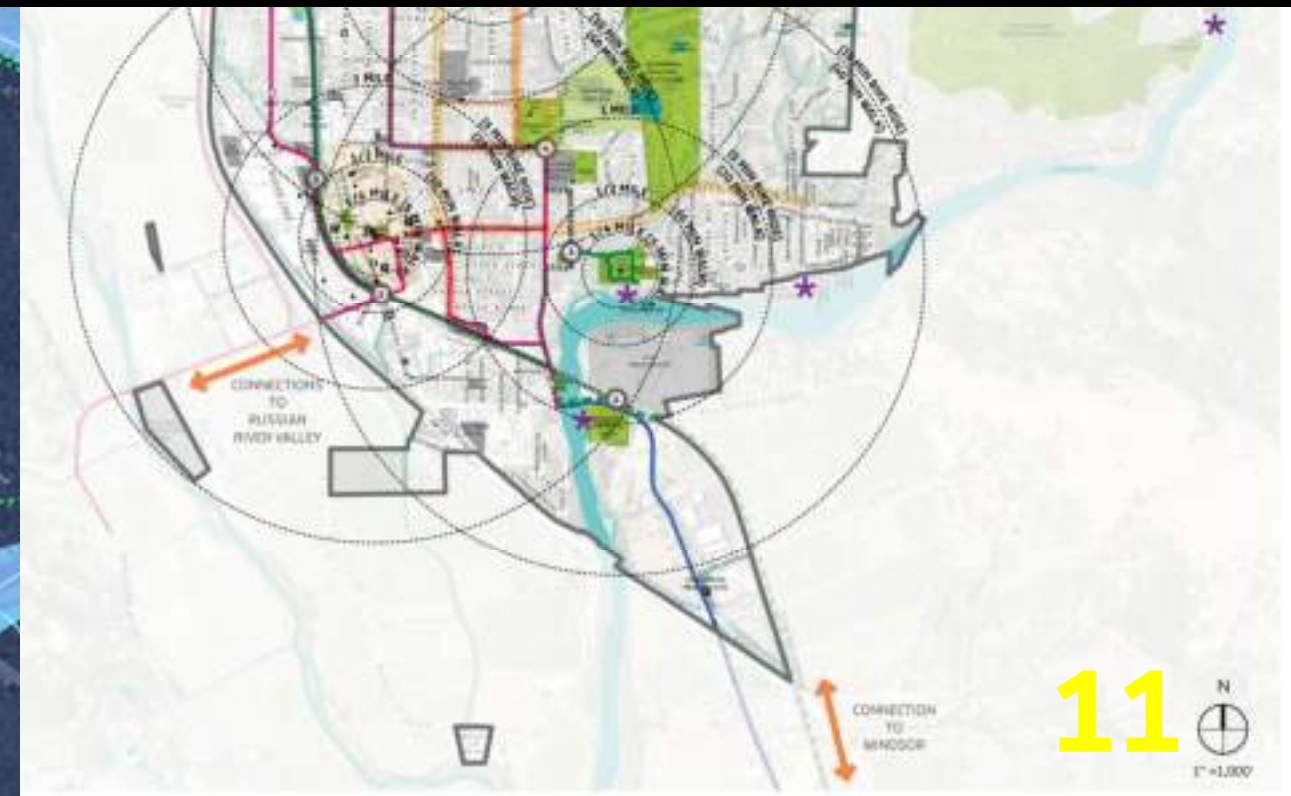
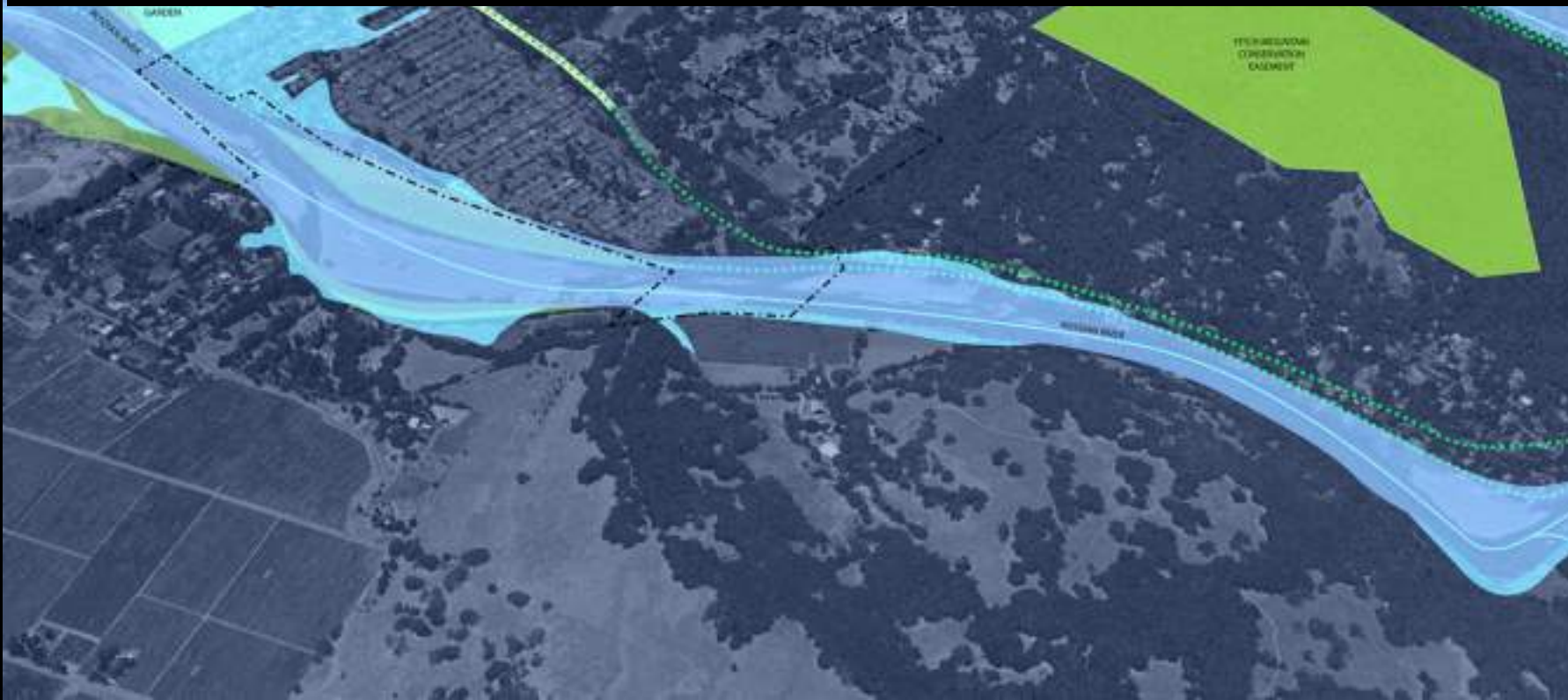

SUNSET SPECTACULAR, LOS ANGELES



BILLBOARD + MUSEUM



GEOLOGY + SERPENT



HISTORY + GEOGRAPHY



SHADOWS + REGISTRATION



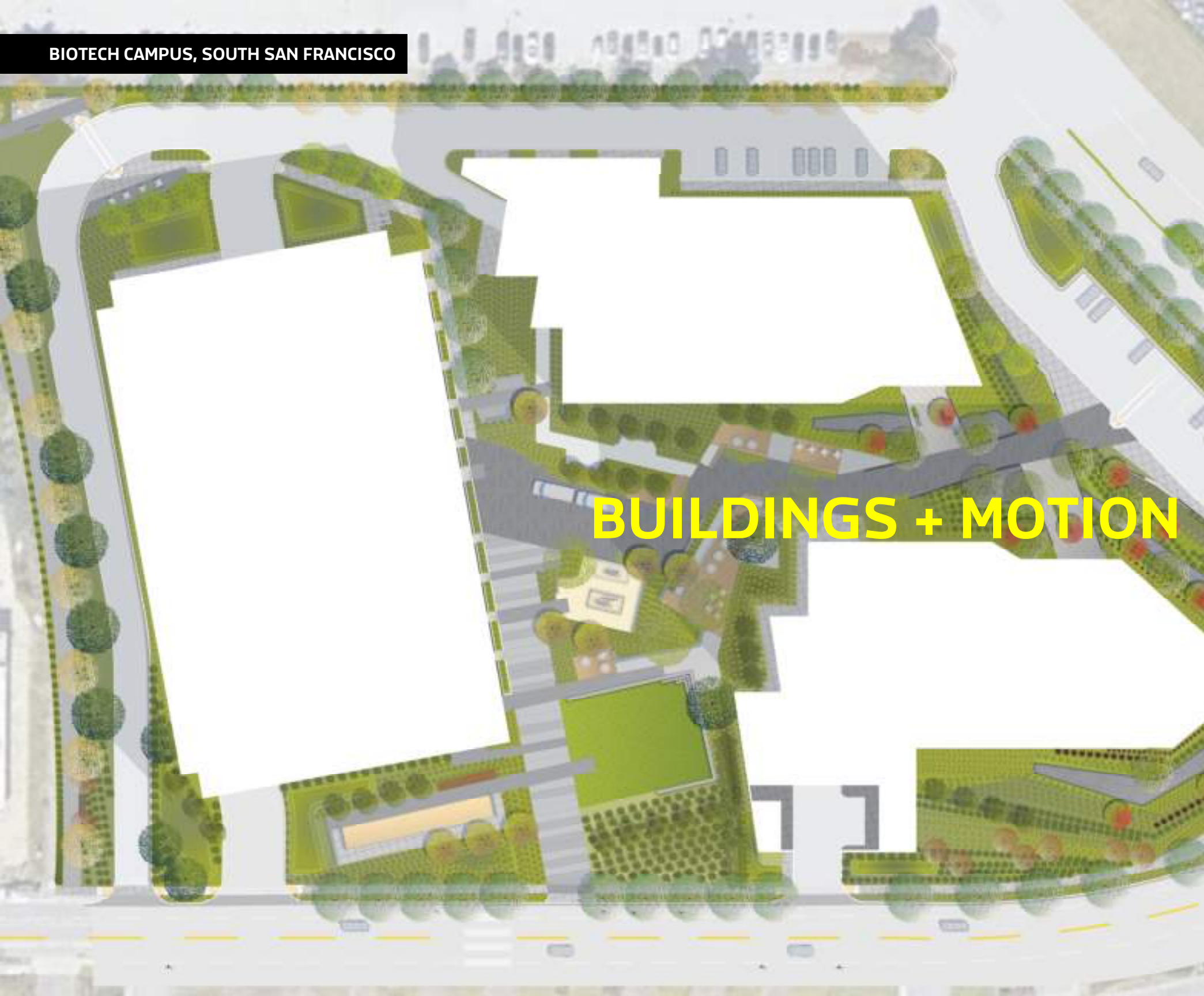

BUILDINGS + MOTION





SOUTH PARK

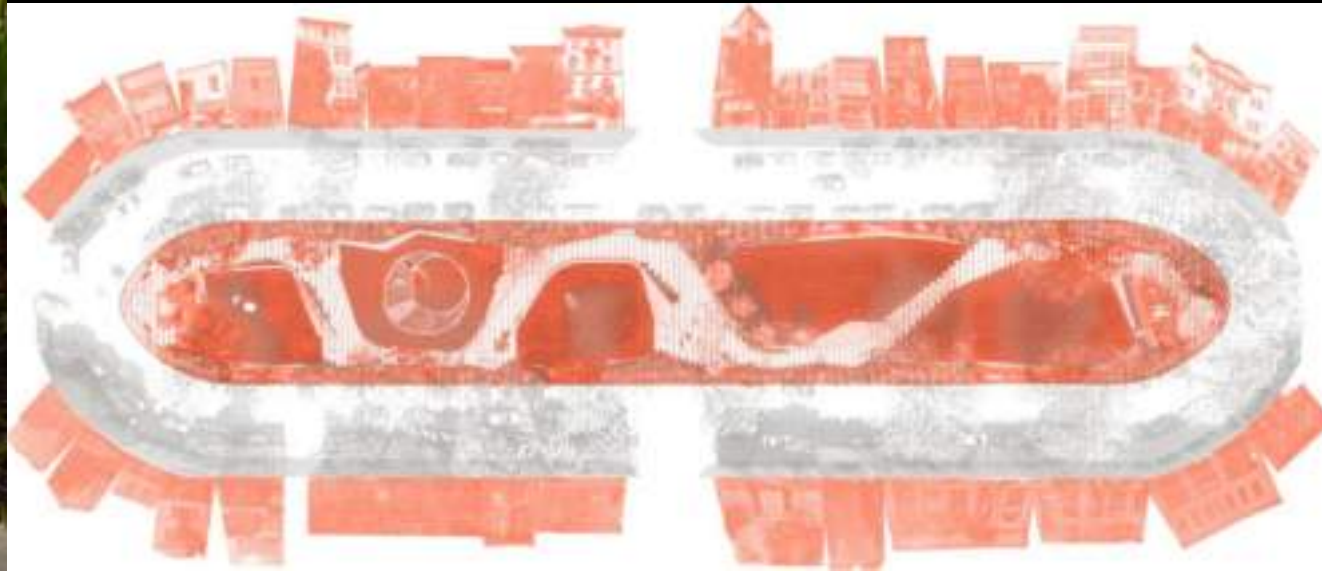



SOUTH PARK: EARLY ANALYSIS AND PARAMETRICS

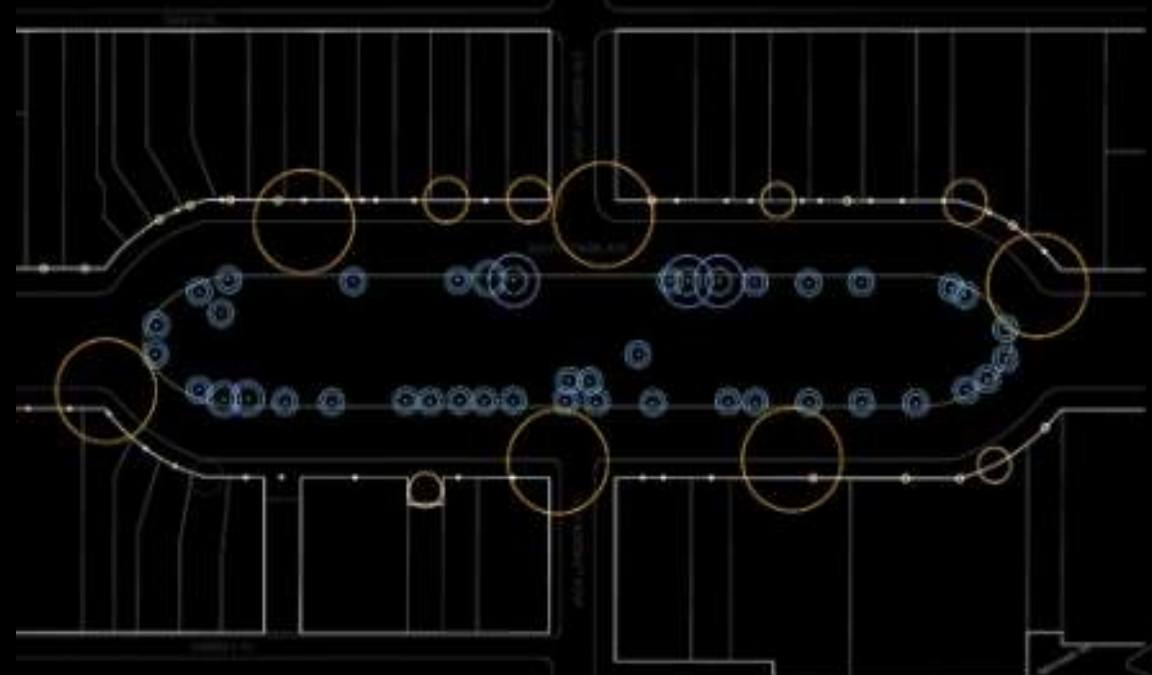
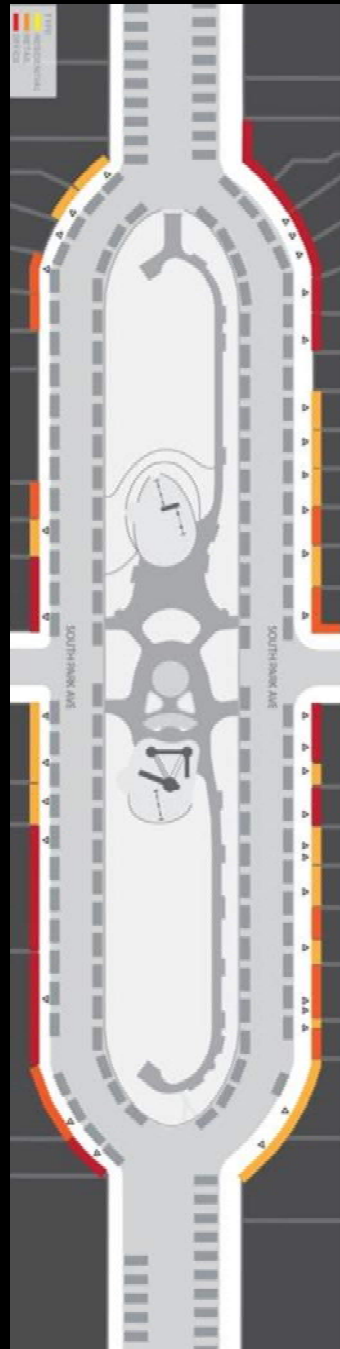

- SITE ATTRACTORS
 - CIRCULATION
 - CAFE
 - DETAIL
 - OFFICE
 - RESIDENTIAL
 - STORAGE
- TREE ROOT PROTECTION BOUNDARY
 - 12"
 - 18"
 - 24"

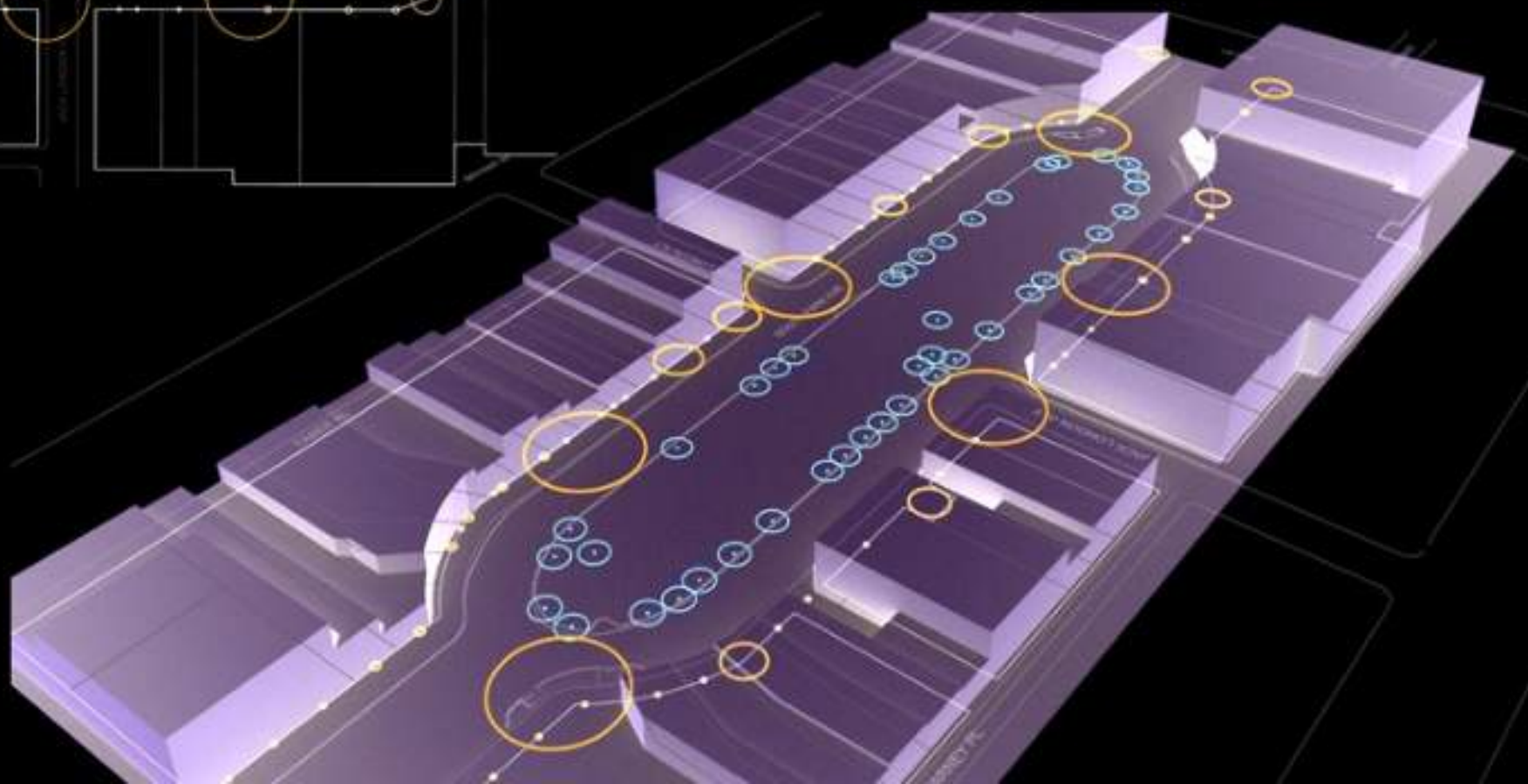

SOUTH PARK: BEFORE AND AFTER AXONS

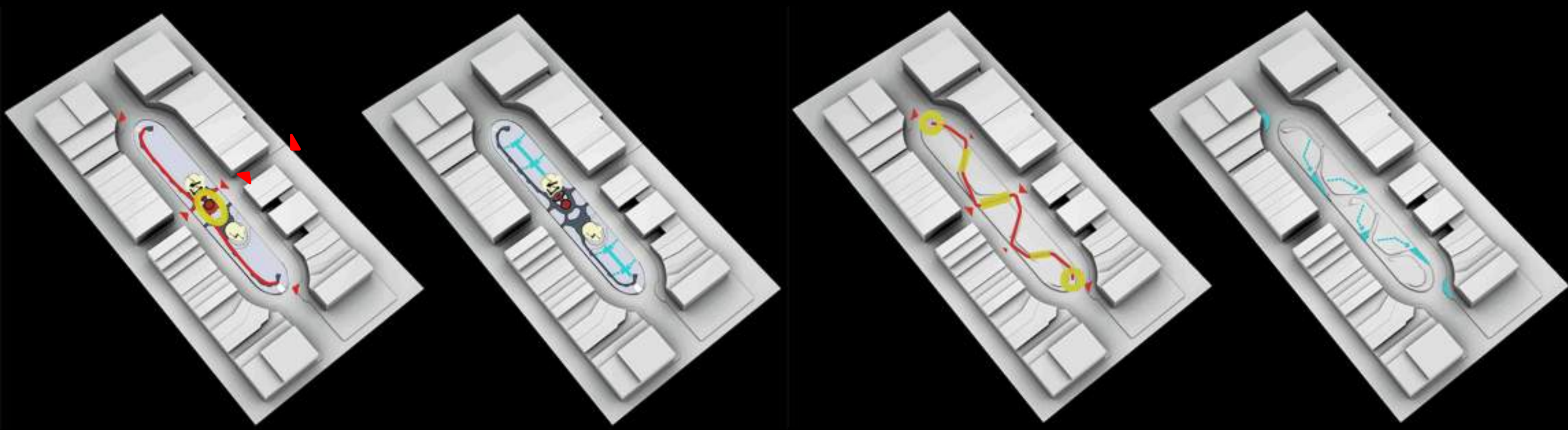

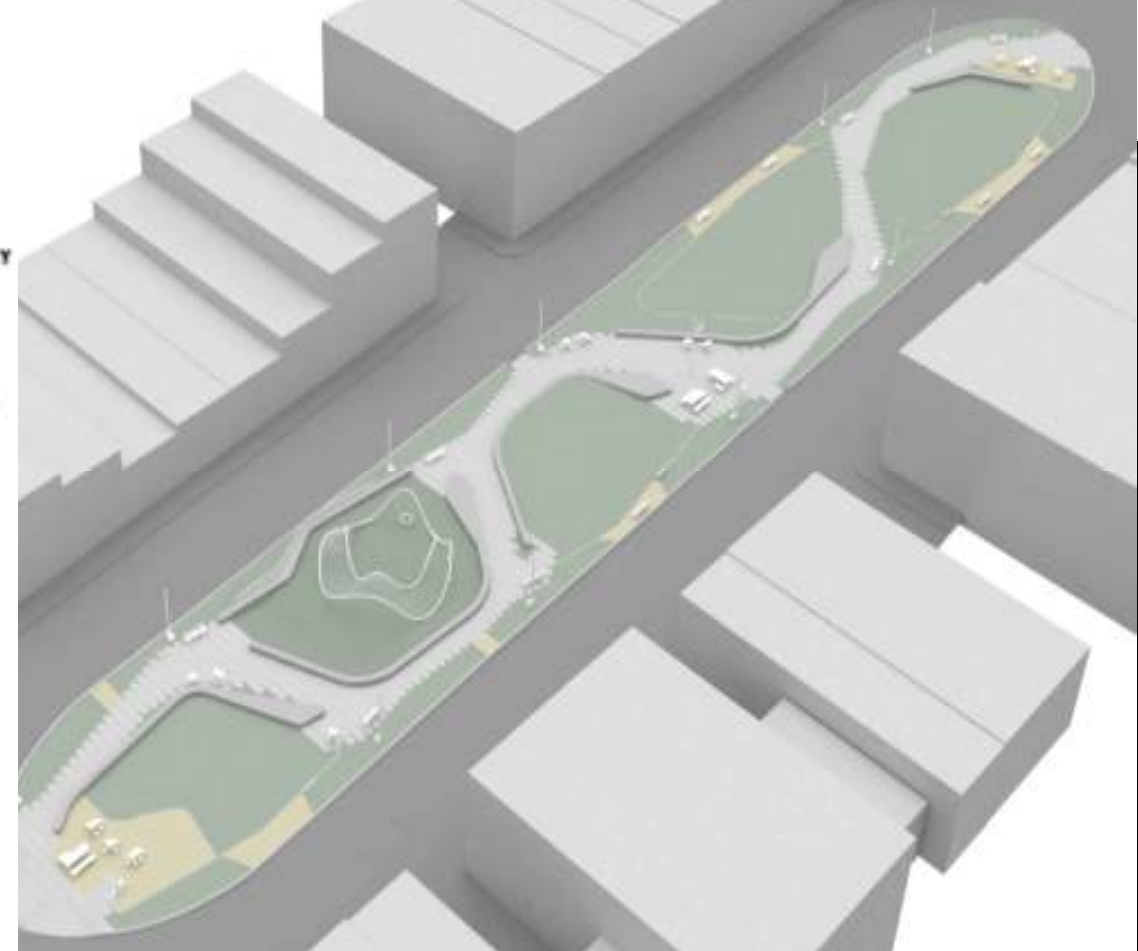
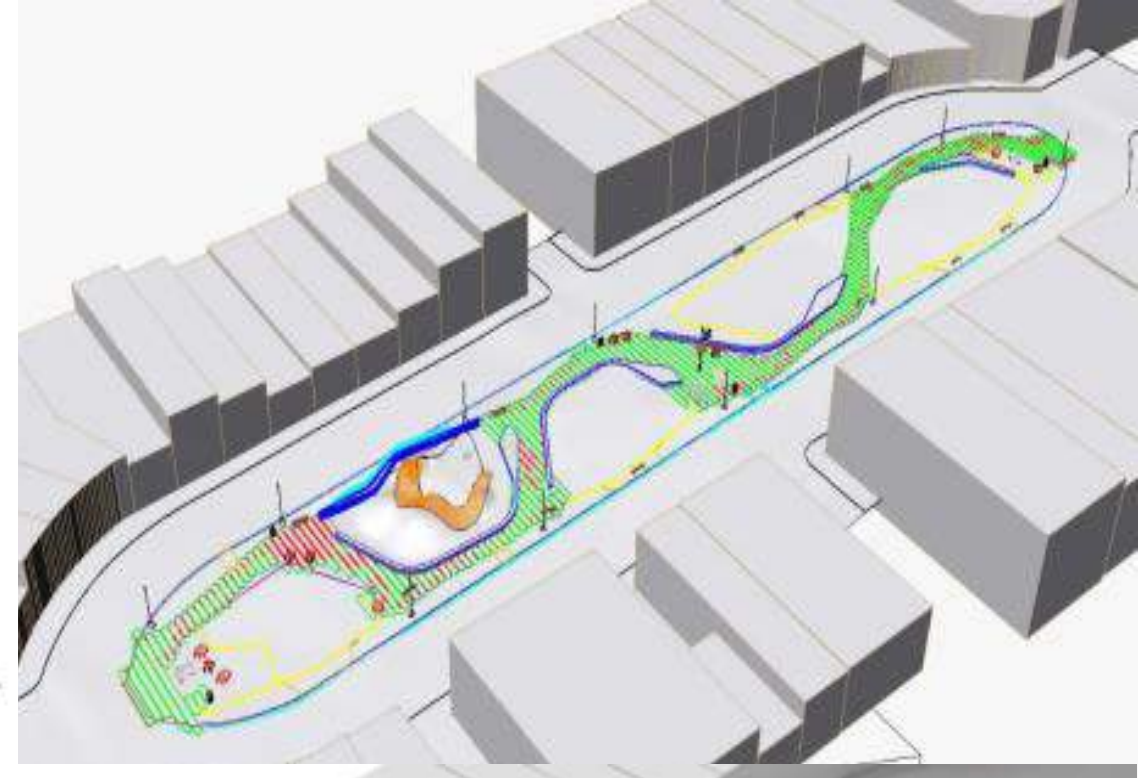
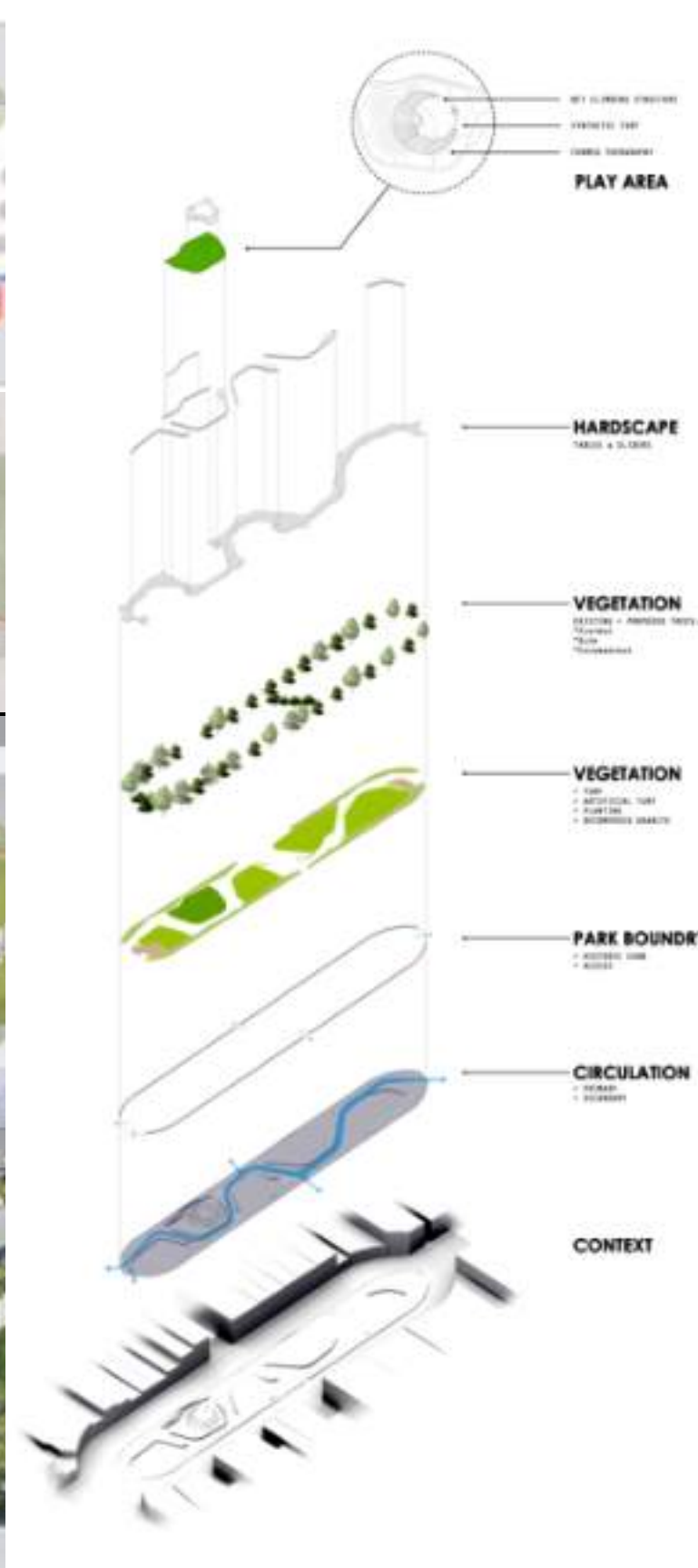
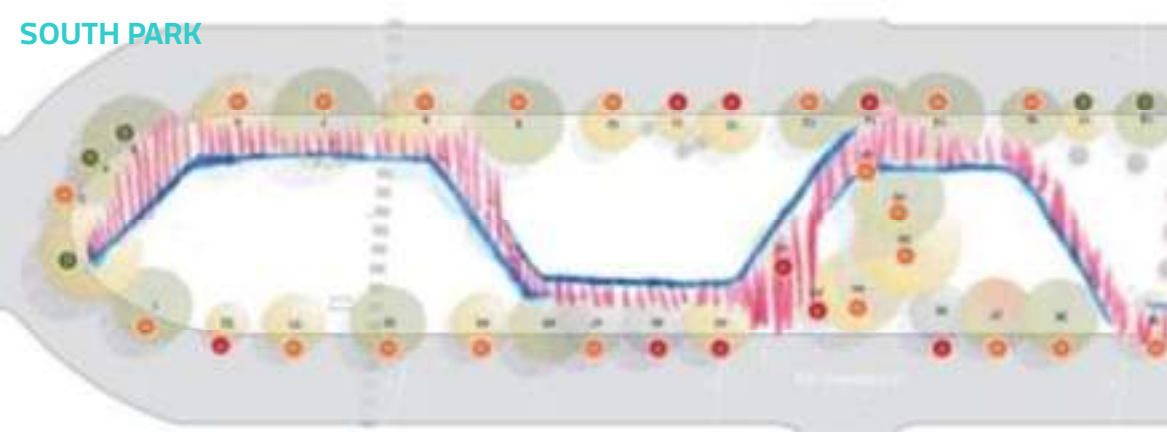

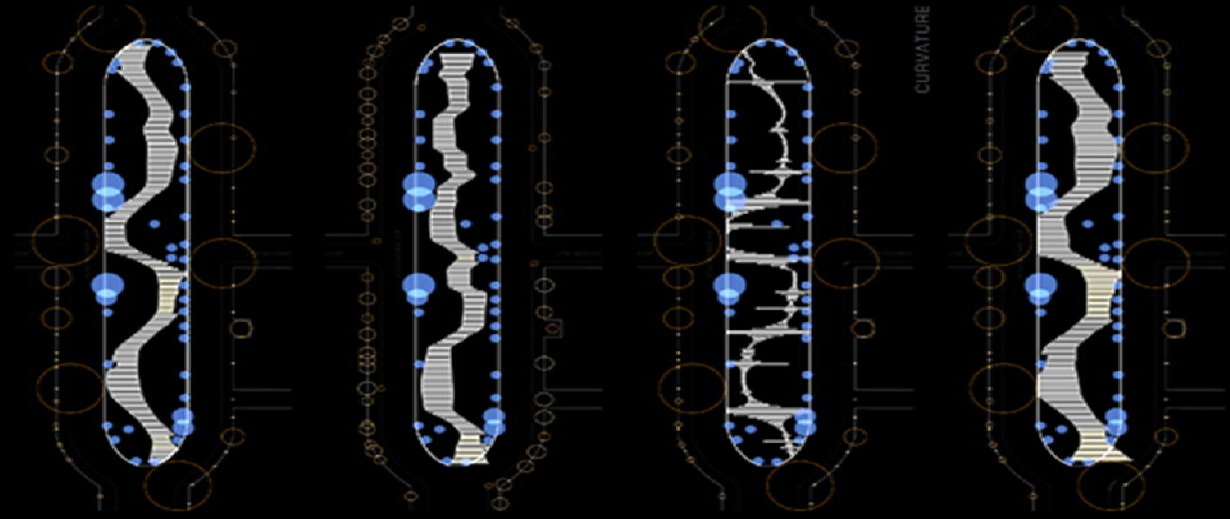
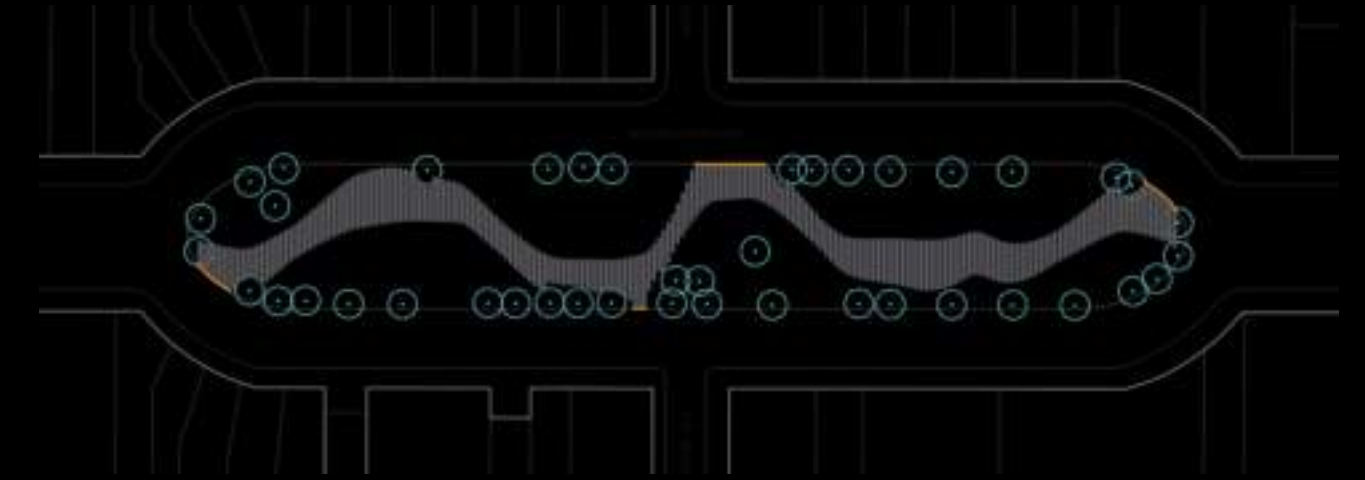
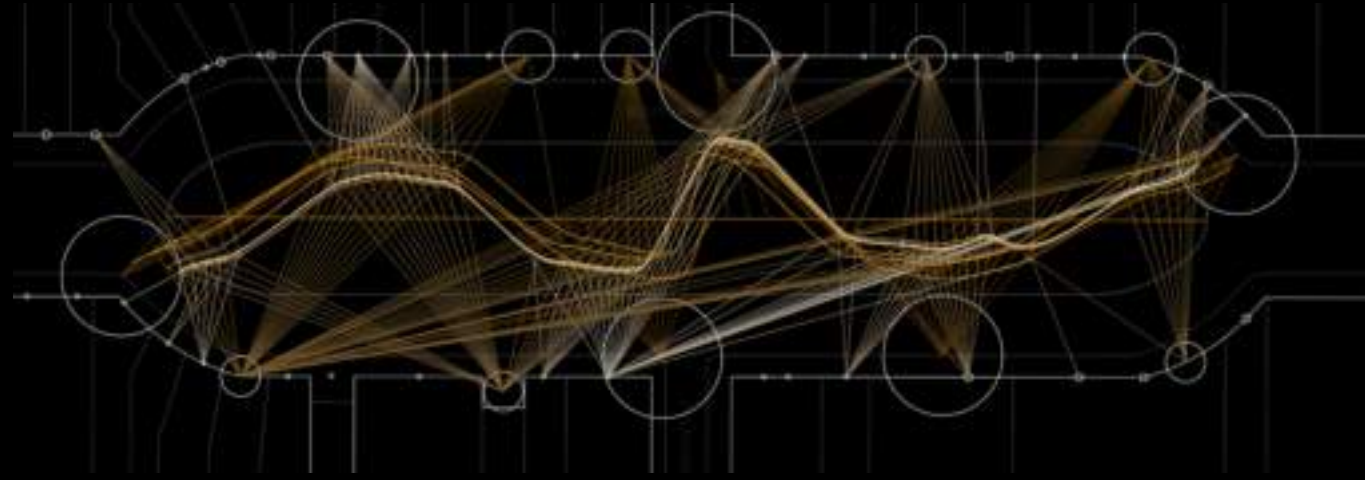
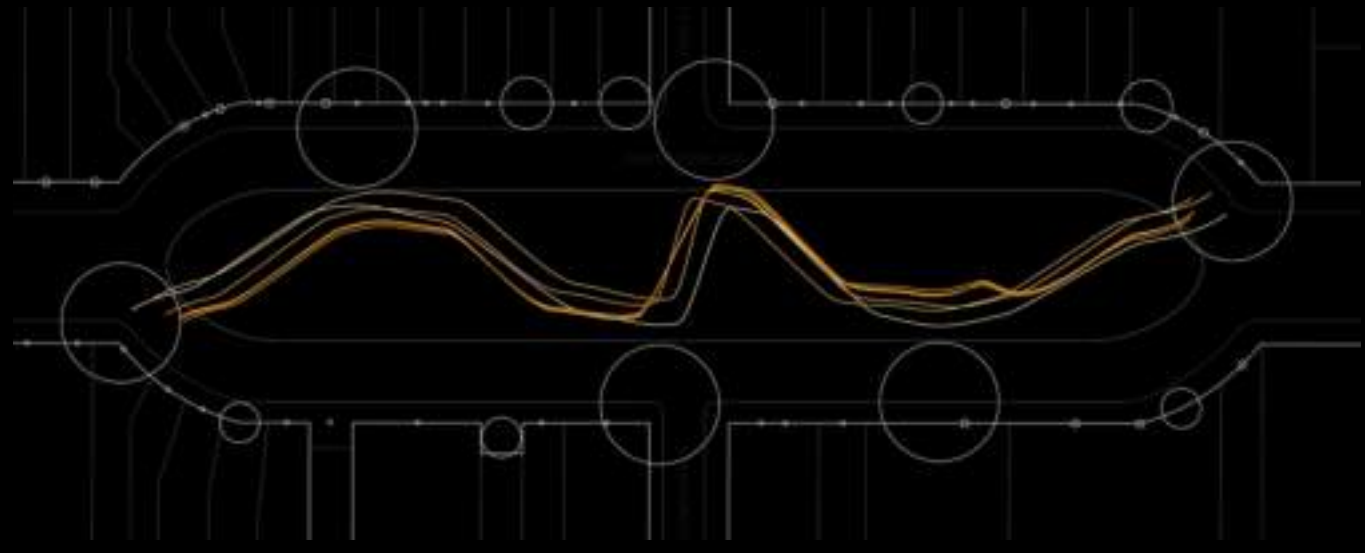

CURVATURE

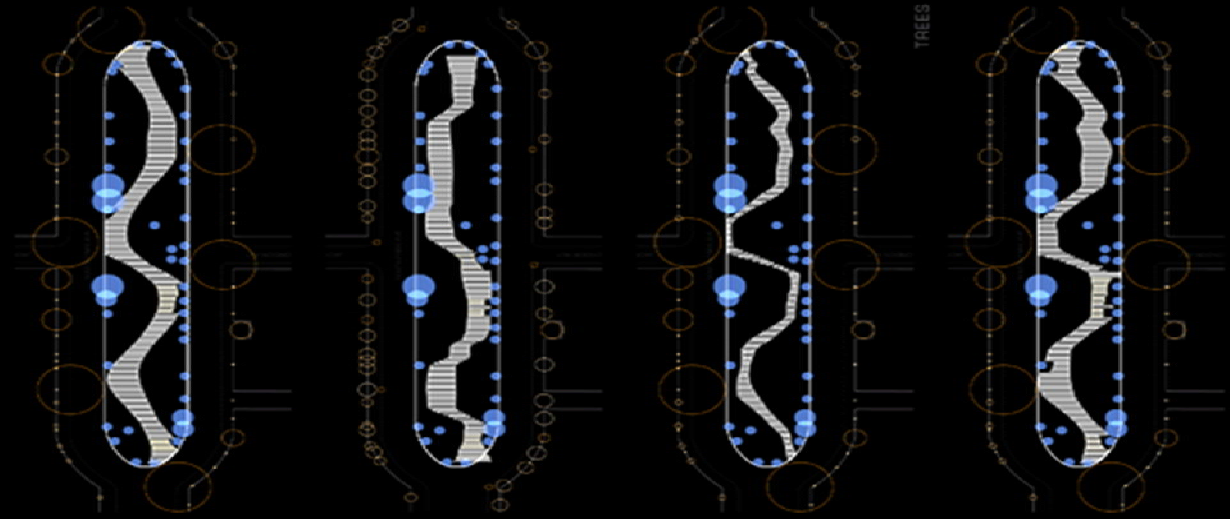

TREES

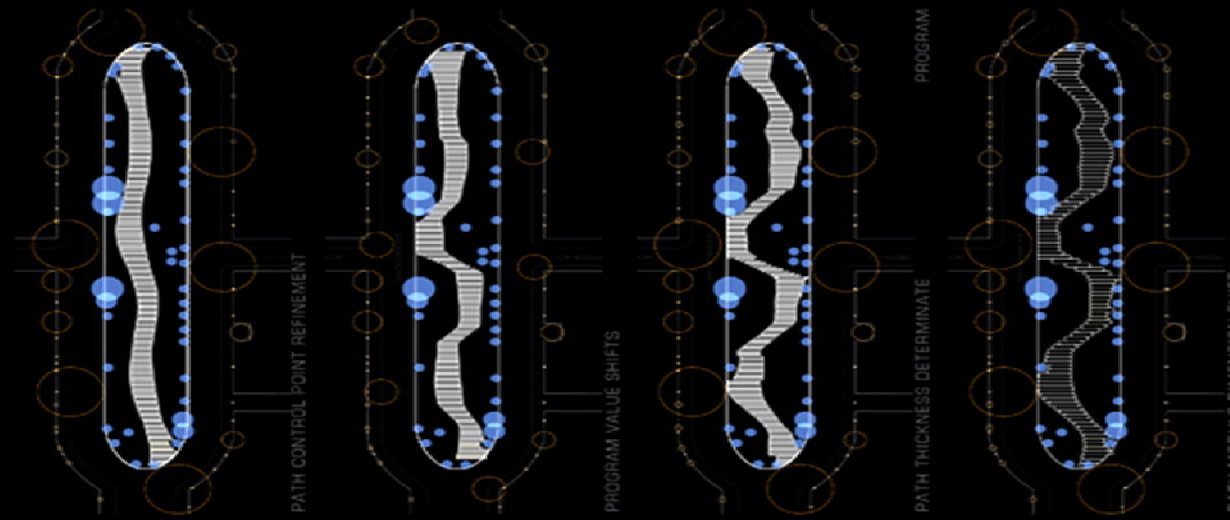

PROGRAM

PATH CONTROL POINT REFINEMENT

PROGRAM VALUE SHIFTS

PATH THICKNESS DETERMINATE









SOUTH PARK

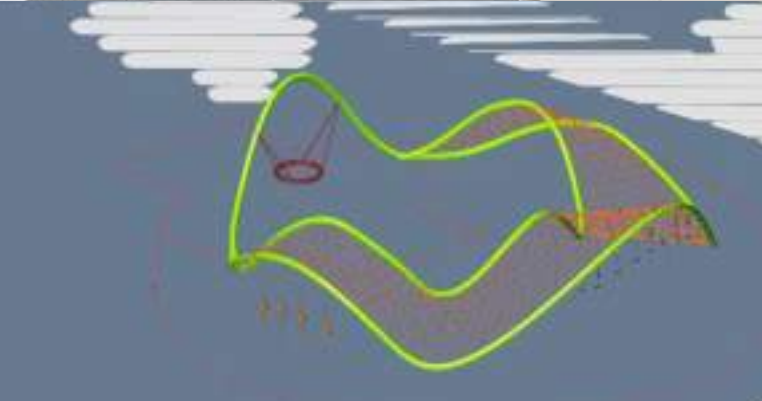
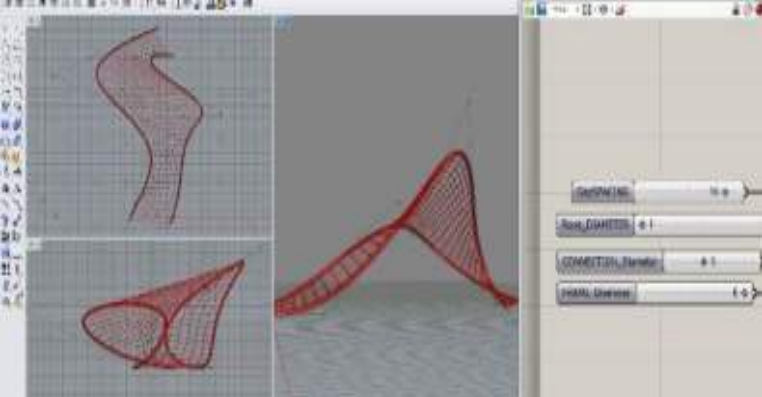



SOUTH PARK





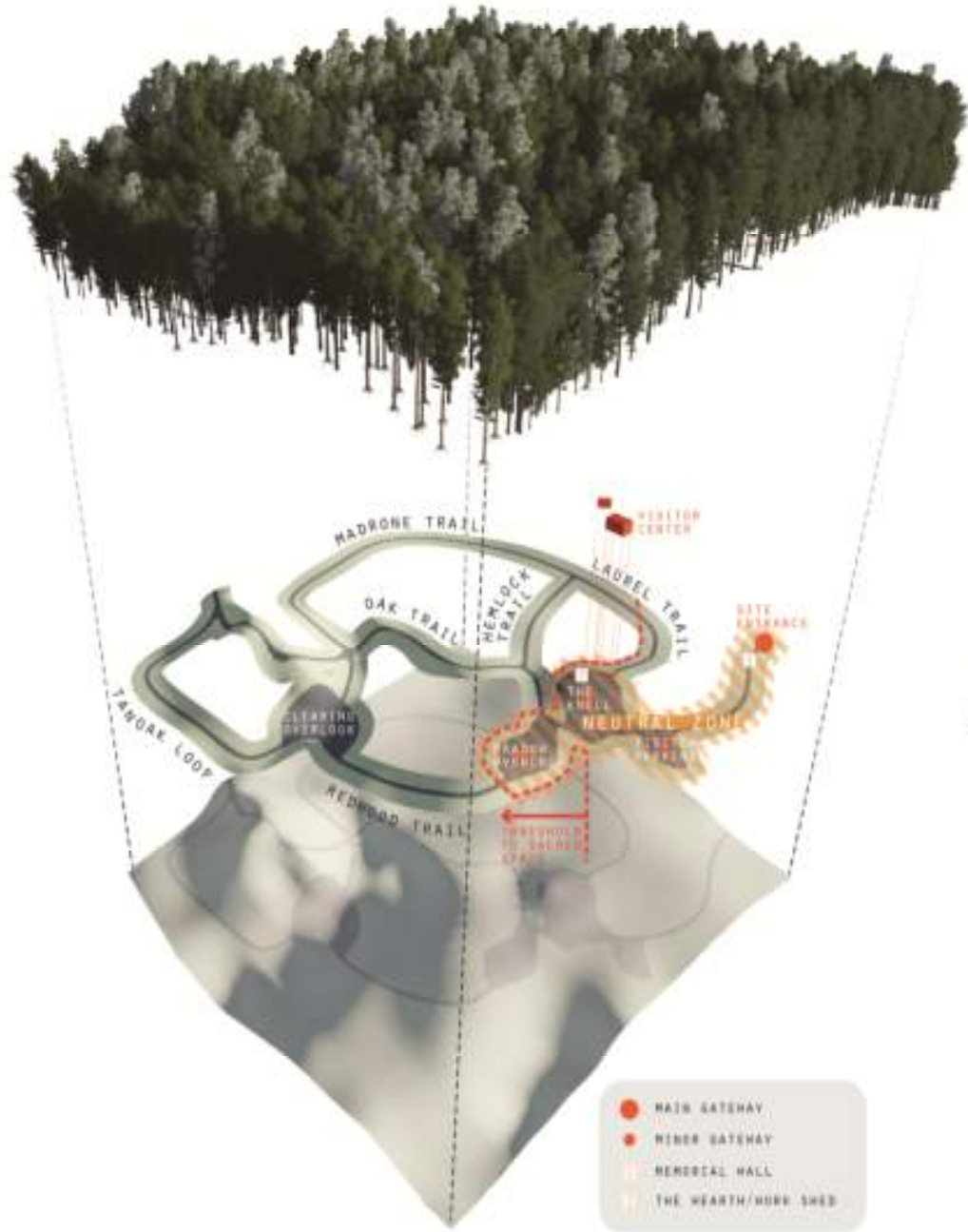





THRESHOLD + REFLECTION



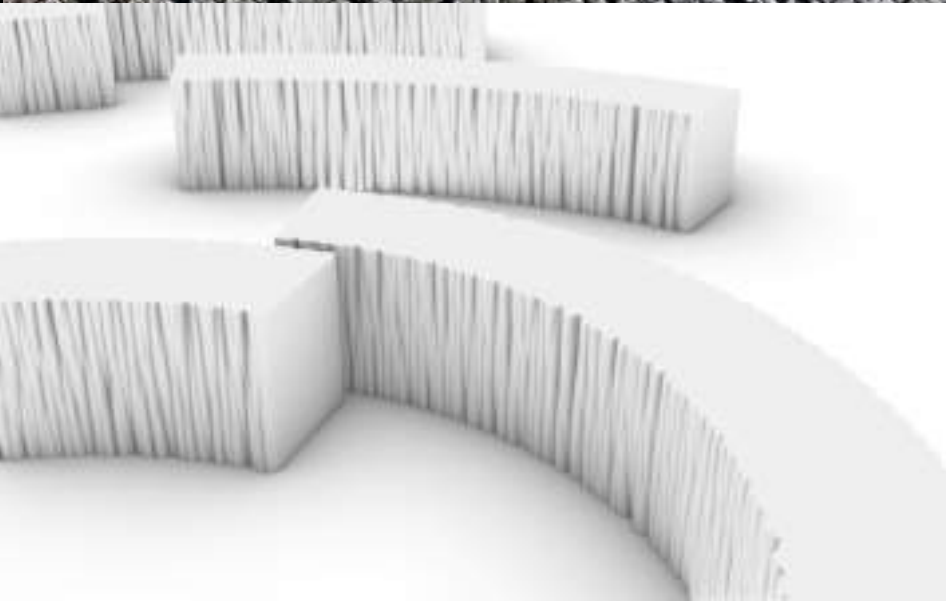

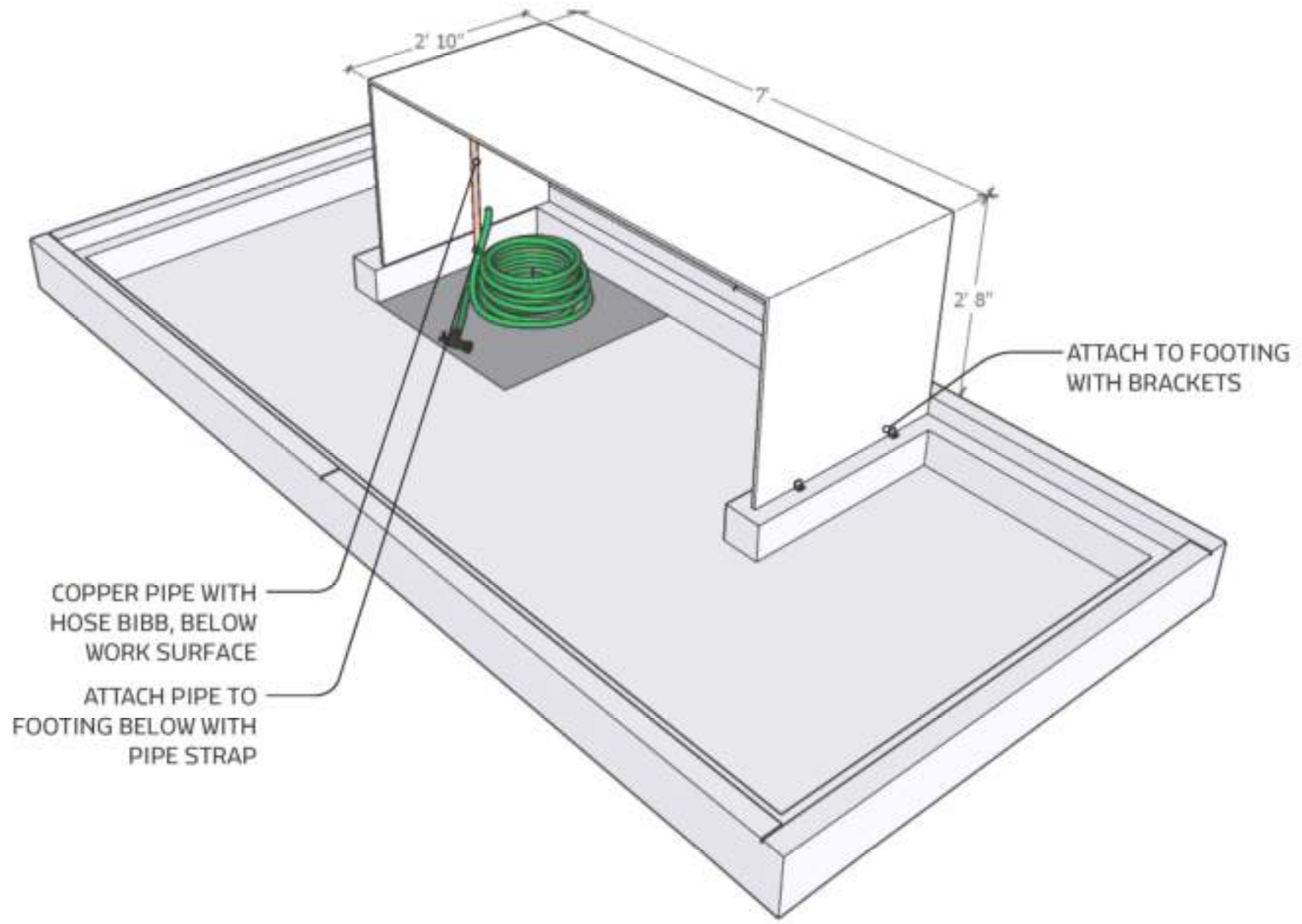

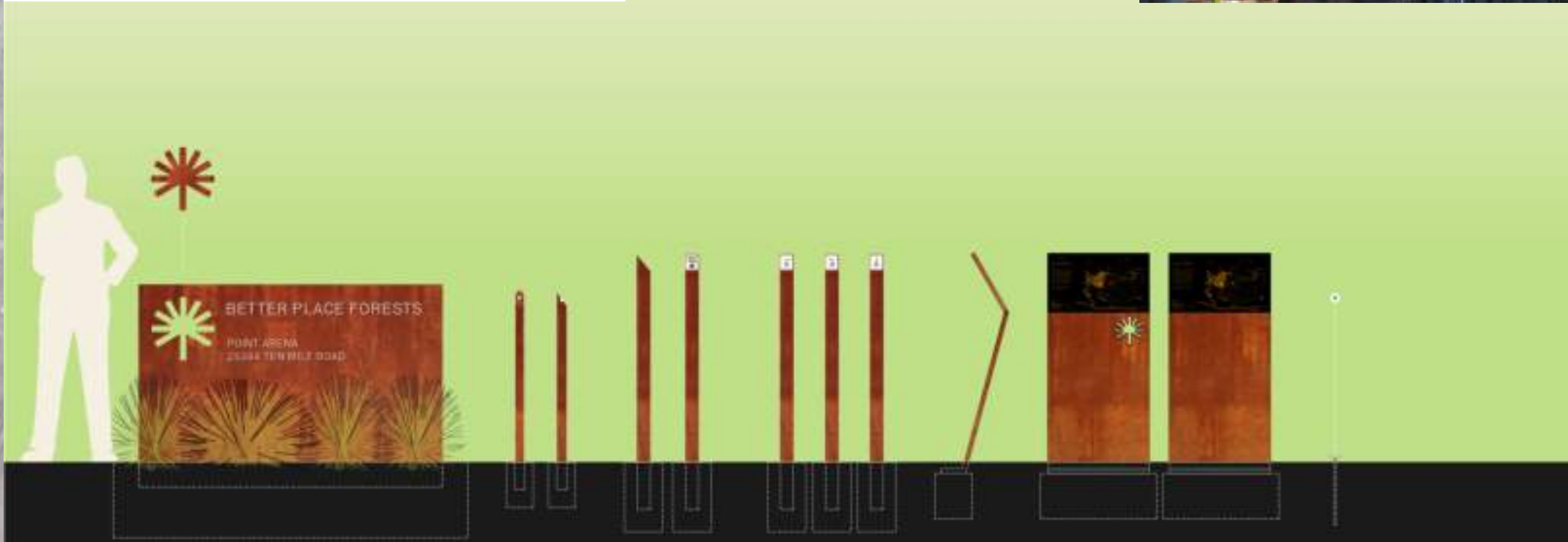
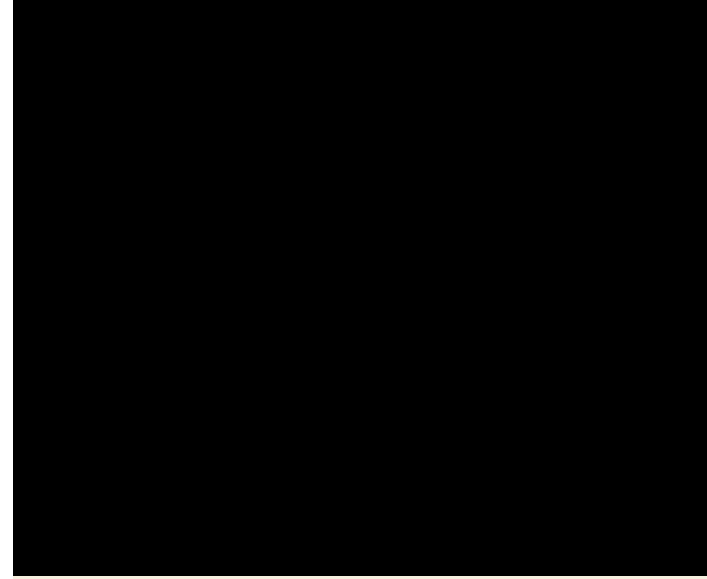
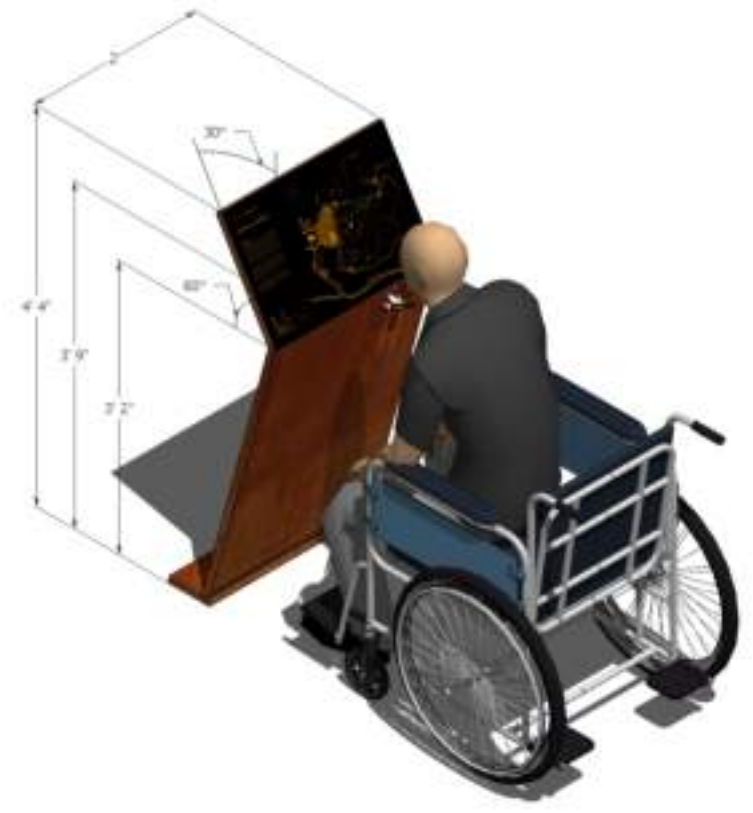

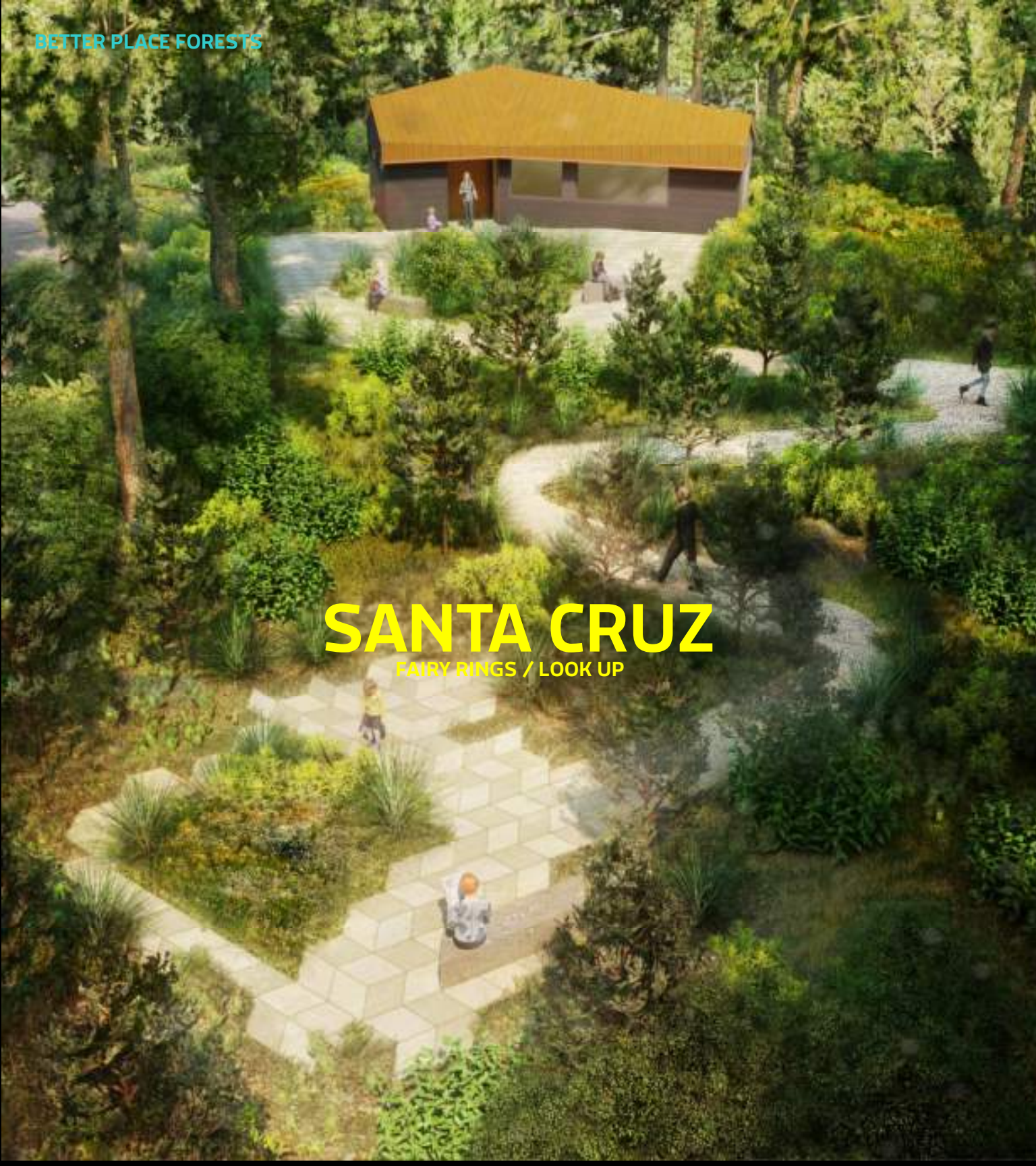

SANTA CRUZ

FAIRY RINGS / LOOK UP



POLLOCK PINES

ARTIFACT + RITUAL

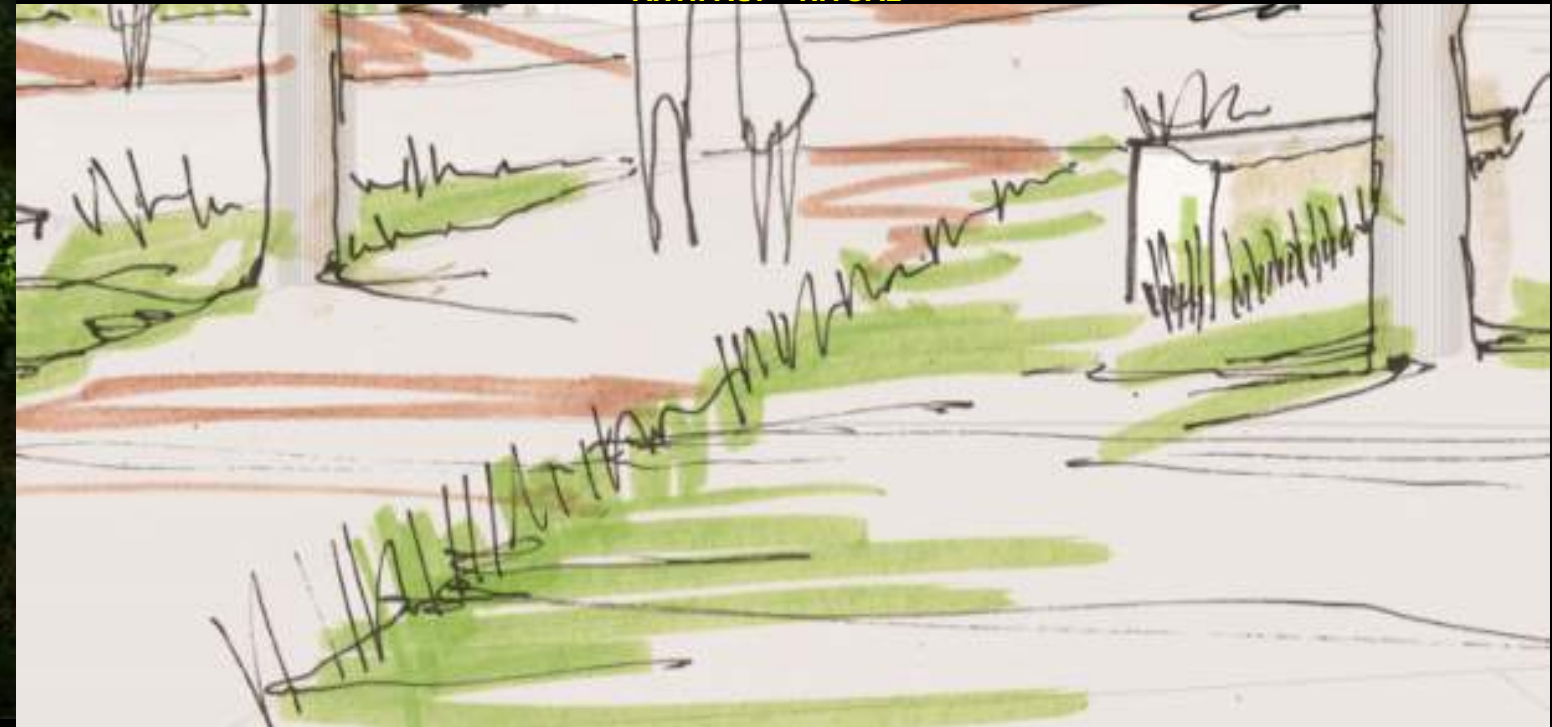

BETTER PLACE FOREST: MARIPOSA
MARIPOSA GROVE + YOSEMITE

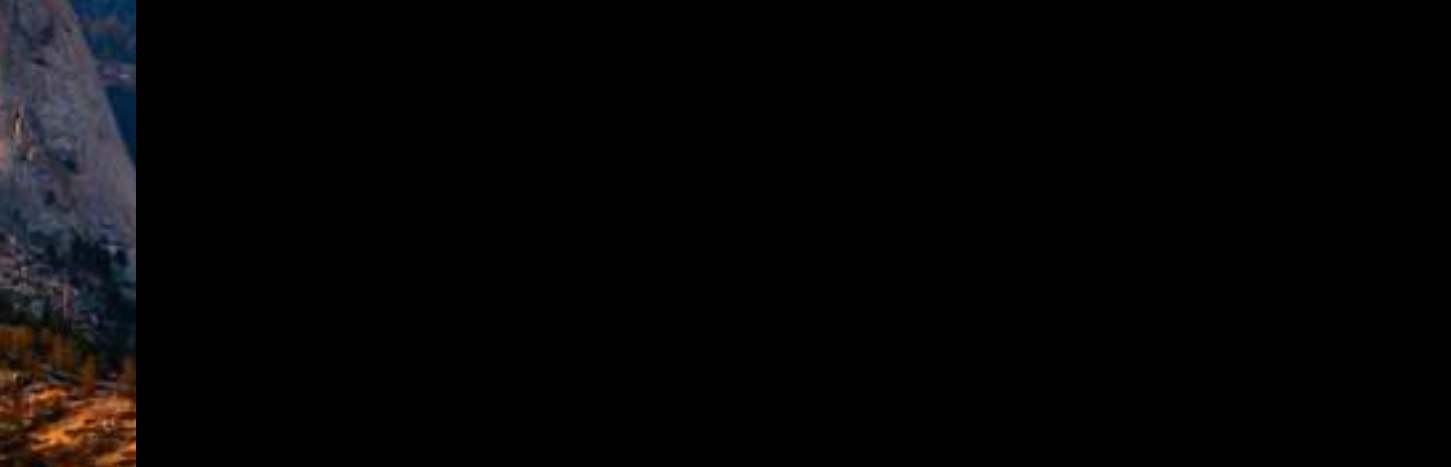

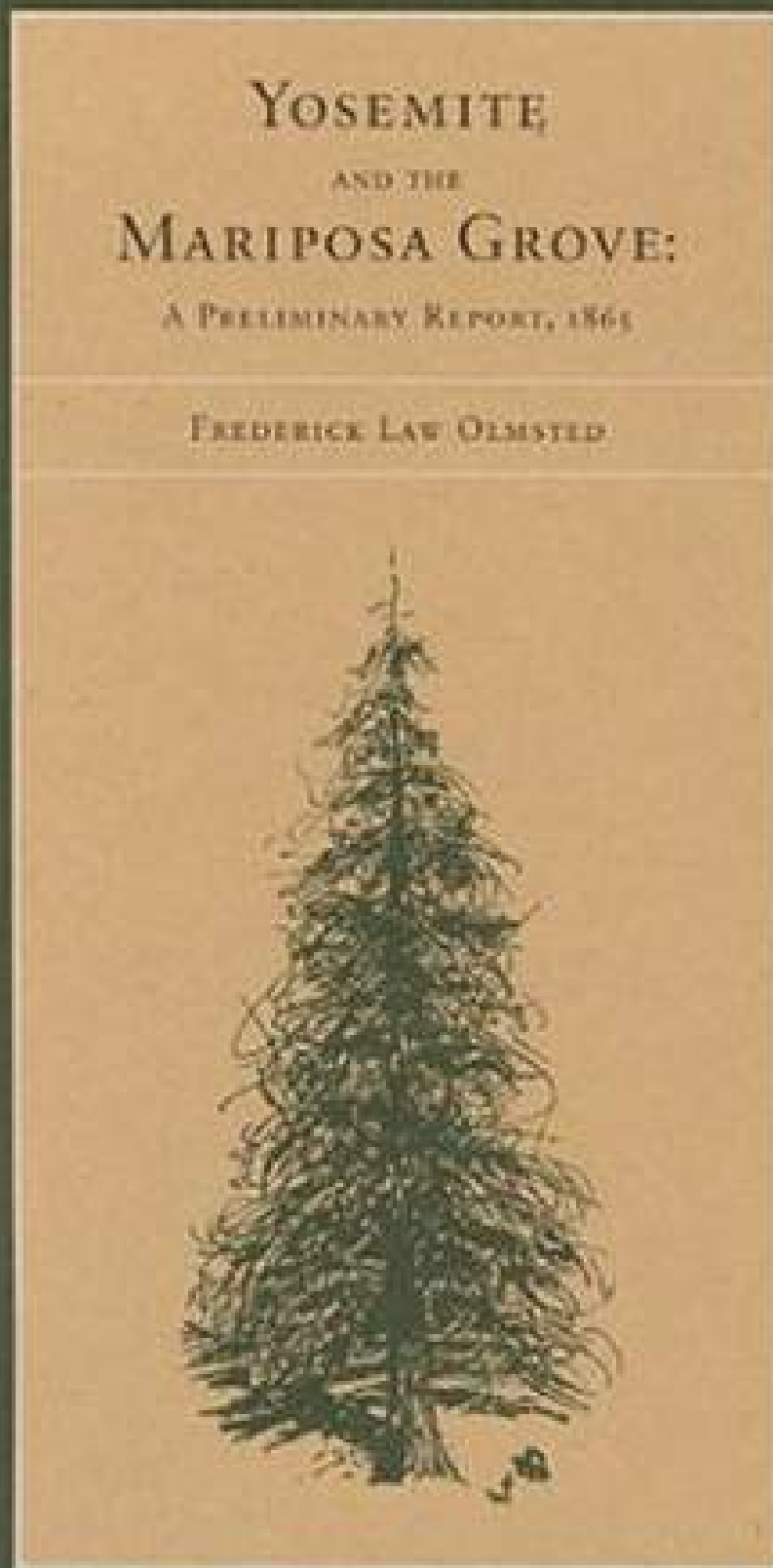

BETTER PLACE FOREST: MARIPOSA
SENSORIUM

TASTE

- SIGHT
- HEARING
- SMELL
- TASTE
- TOUCH
- BODY AWARENESS / BALANCE

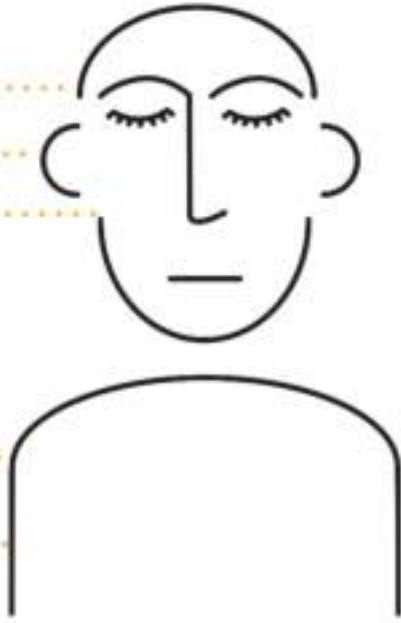

SIGHT



HEARING



SMELL

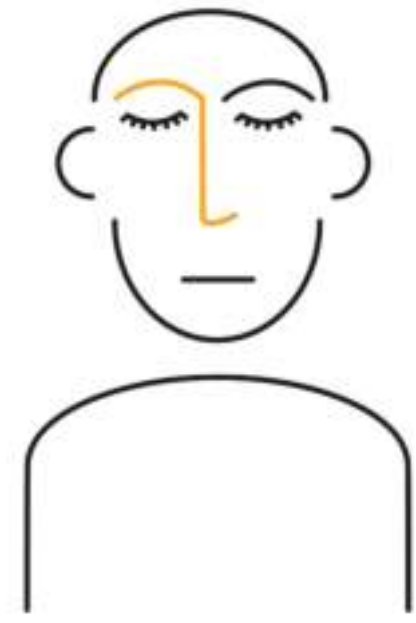

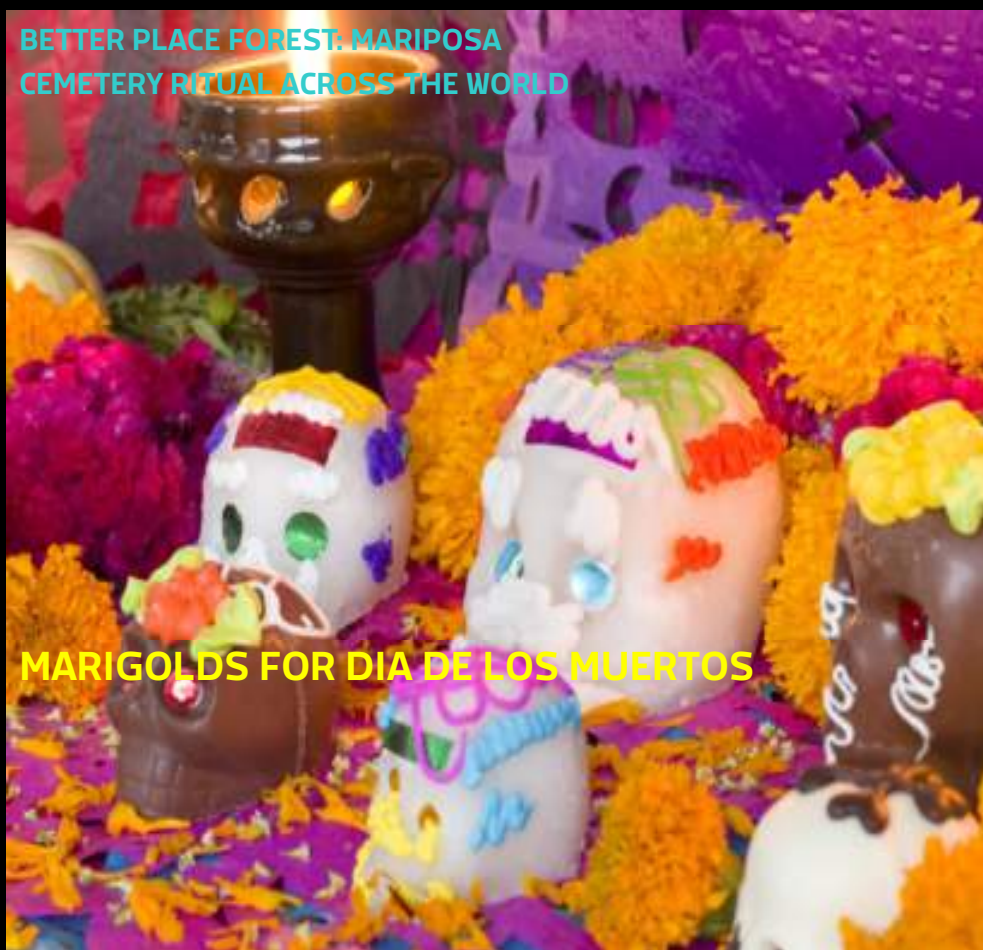

MARIGOLDS FOR DIA DE LOS MUERTOS



LEAVING STONES AT GRAVESIDE (JUDAISM)



CHIMES + GONGS



CAIRN BUILDING



FAMILY TREE PLANTING



COMMUNITY TREE (1 TREE = 1,000 LIVES)

1871 PRE INDUSTRIAL DOGPATCH

POTRERO HILL + DOGPATCH, SAN FRANCISCO

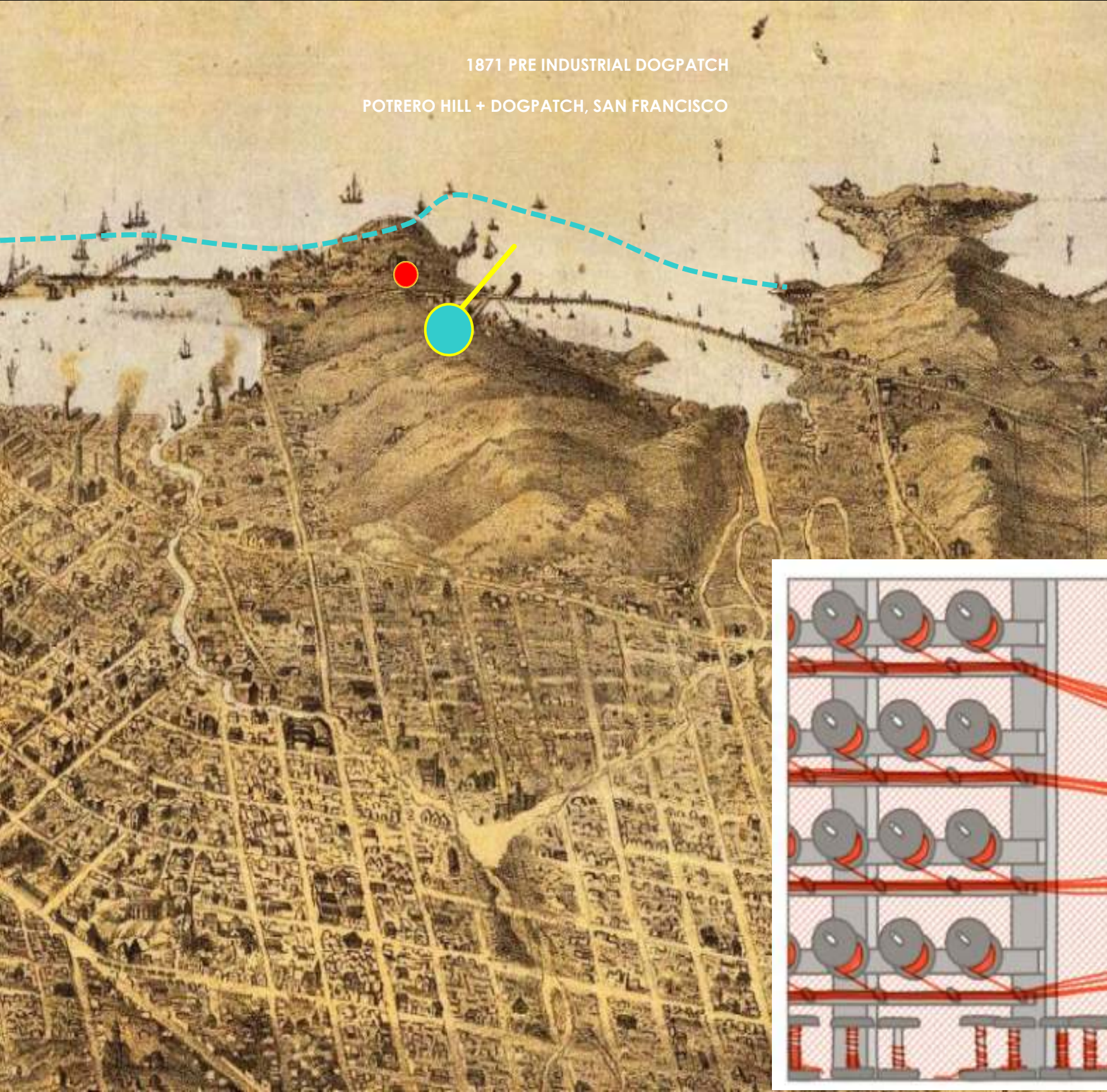

THE DOGPATCH ROPEWALK

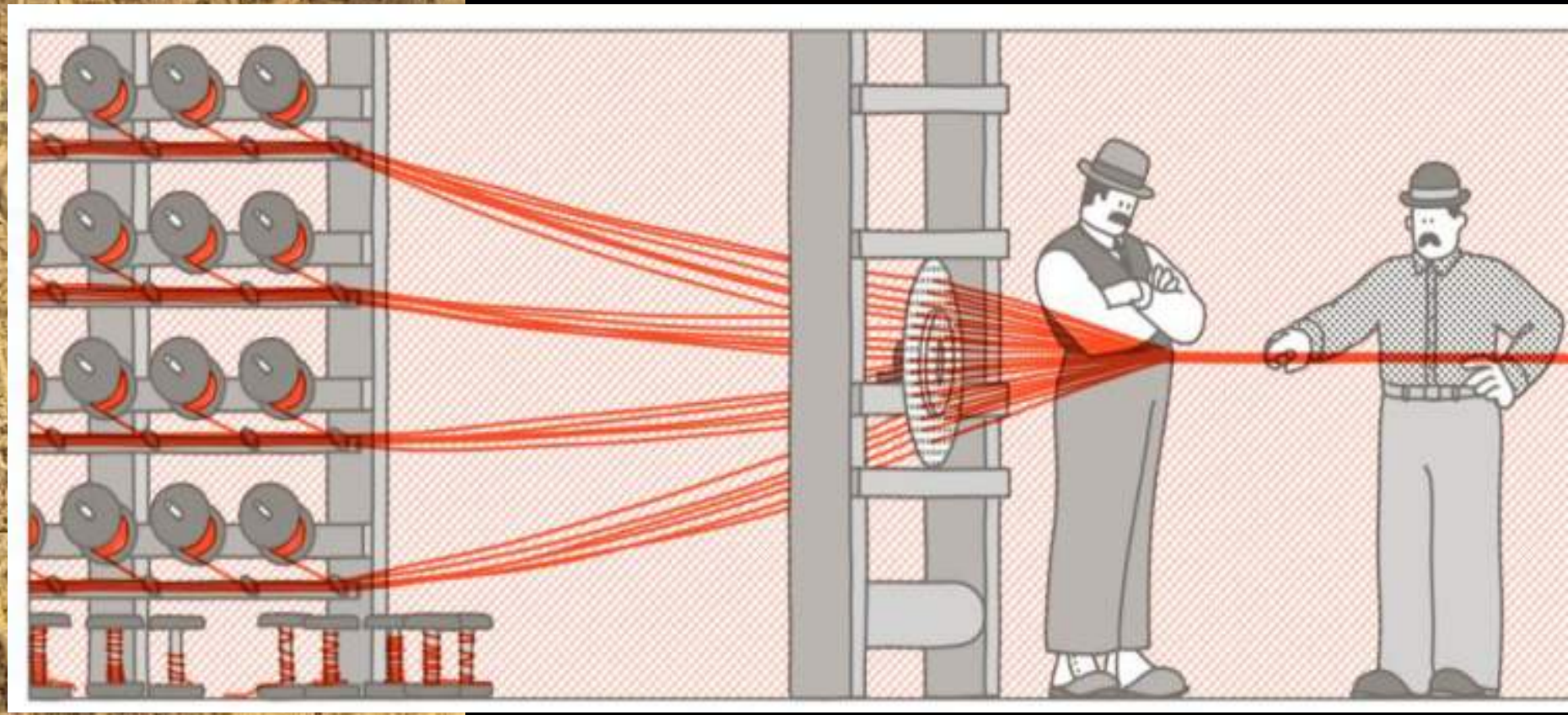



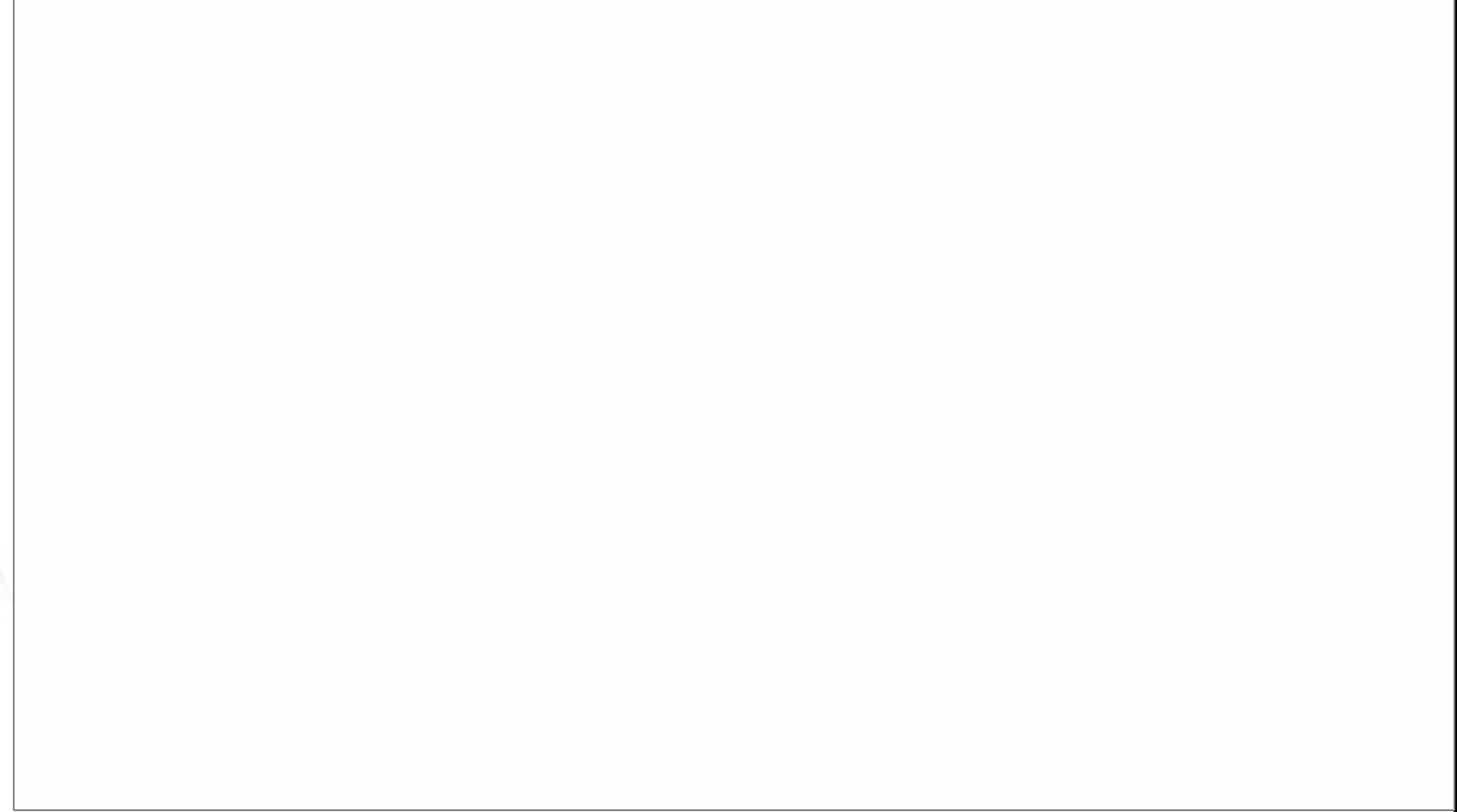
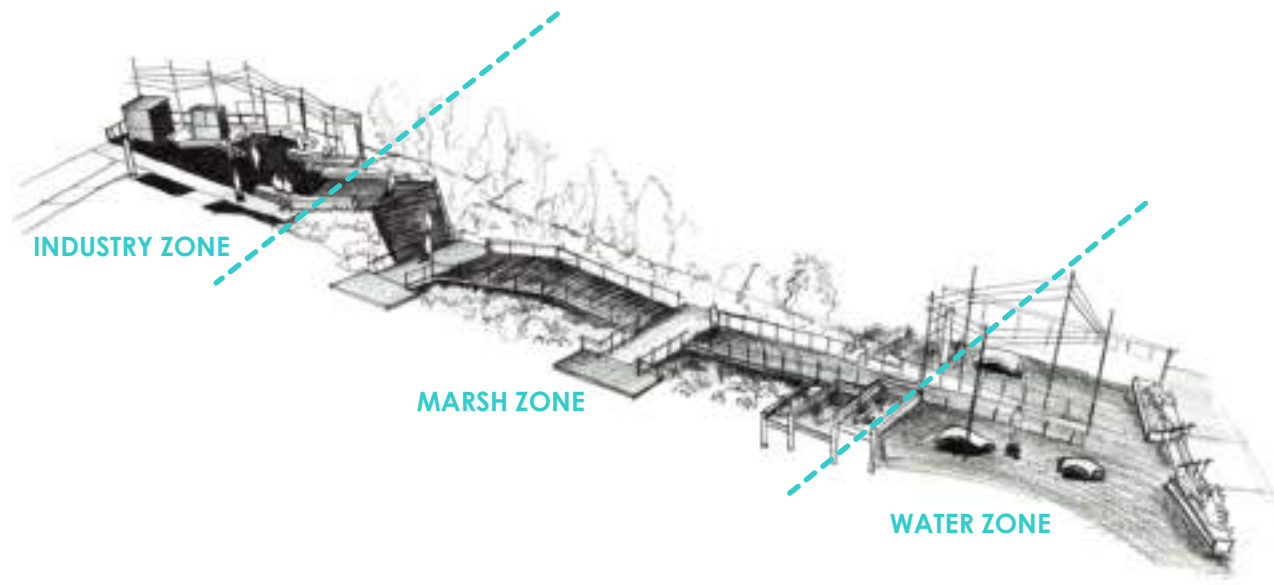



Grid disruption
1. Grid disruption
2. Disruption - separate steps
3. Top of disruption







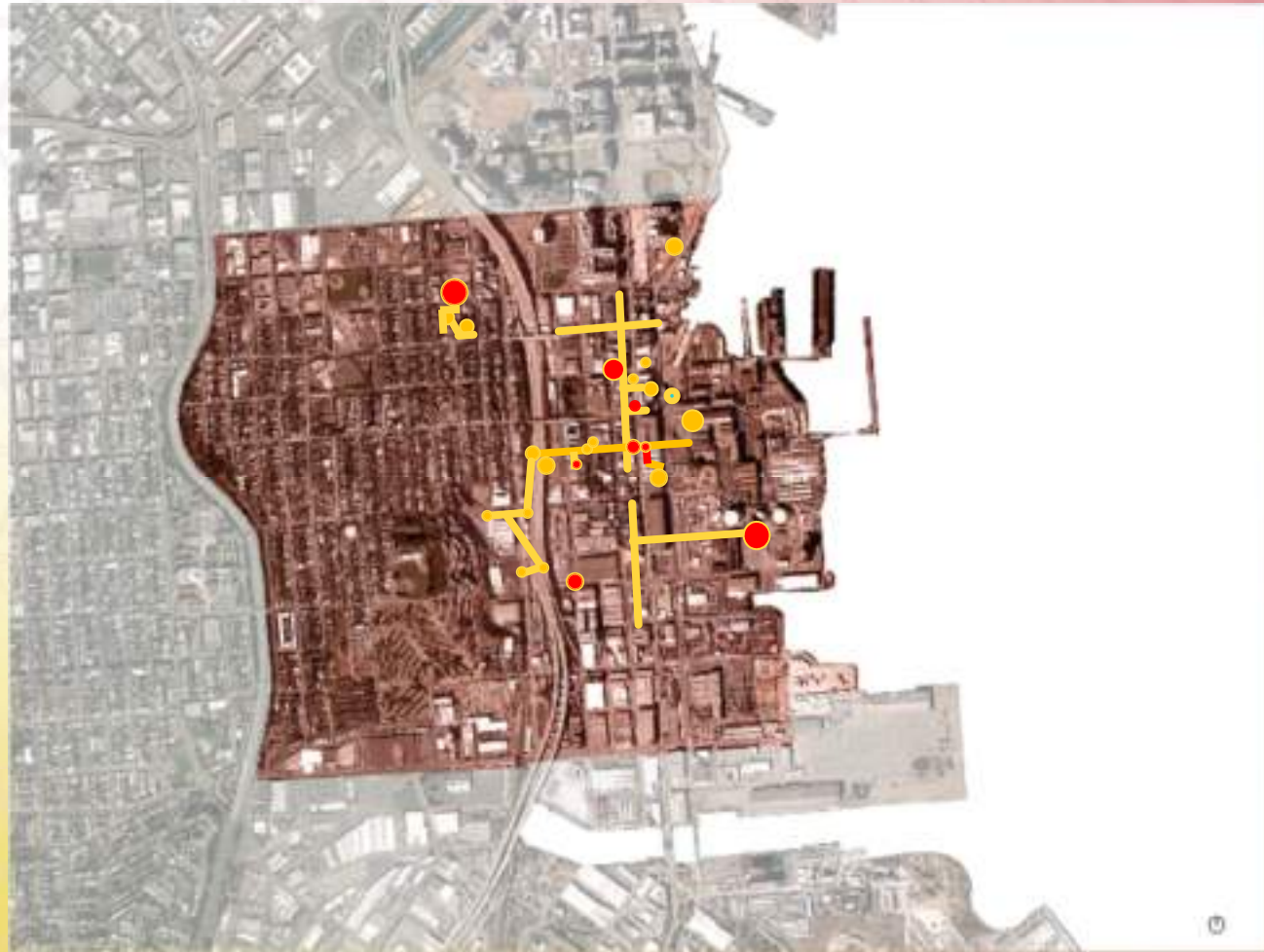

hope + space

4% of Fletcher Studio's time
is devoted to pro-bono
community projects...

+ PROJECTS THAT BEGAN WITH
PRO-BONO SERVICES

SAN FRANCISCO

SAN FRANCISCO

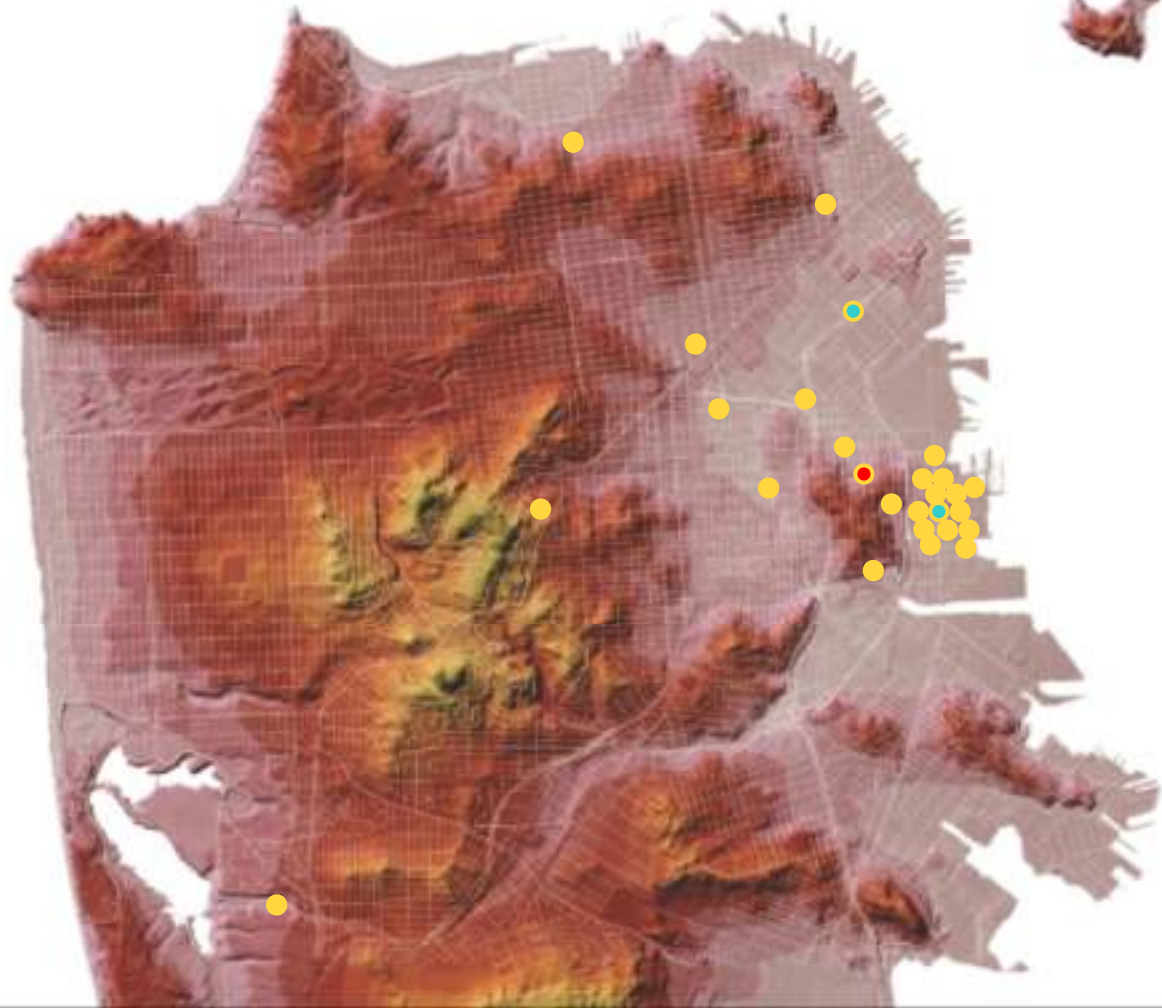

SAN FRANCISCO

POTRERO HILL + DOGPATCH, SAN FRANCISCO

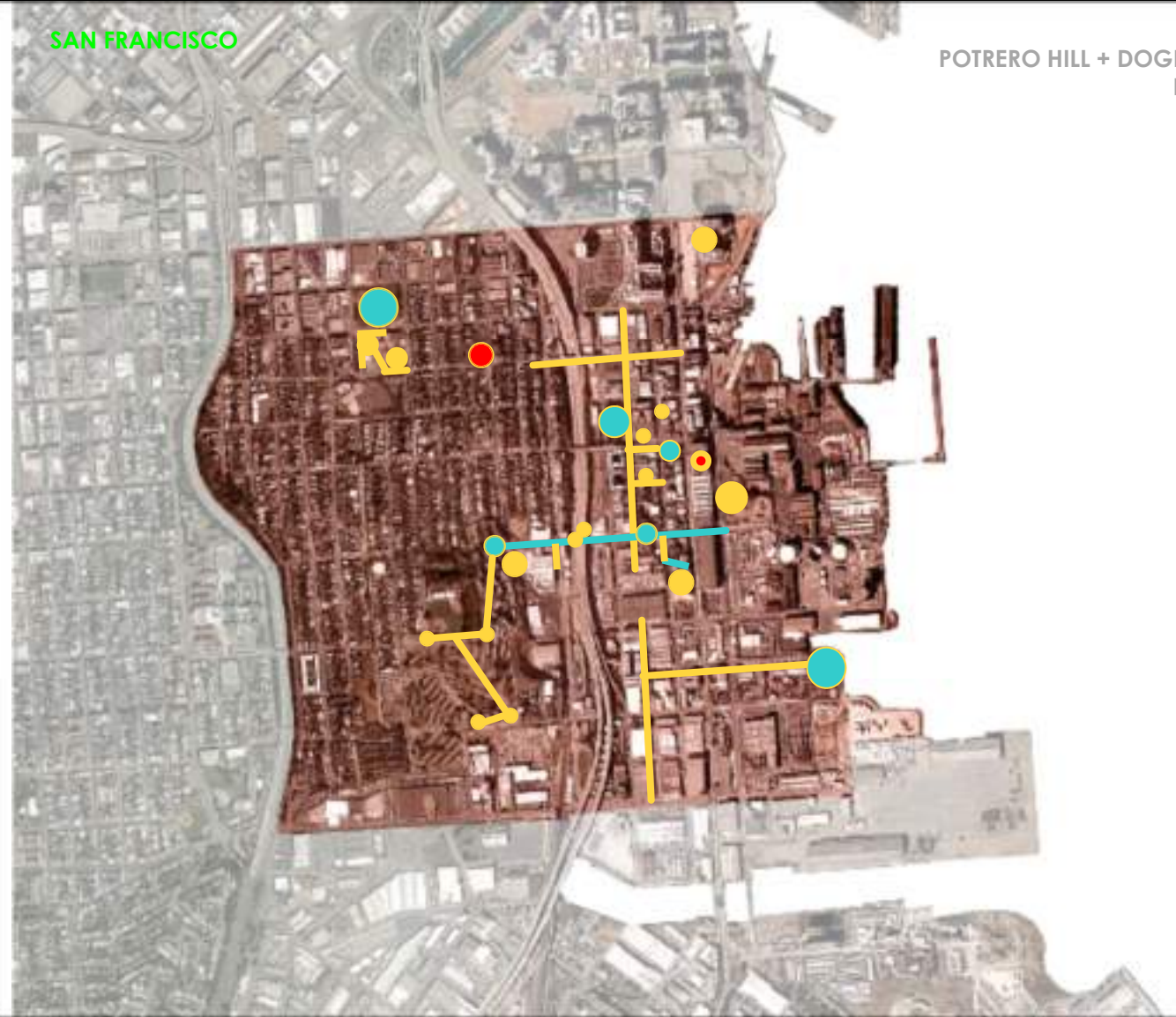



hope + space

4% of Fletcher Studio's time is devoted to pro-bono community projects...

+ PROVIDING FREE DESIGN SERVICES TO SUPPORT NEW PROJECTS AND FUNDING



hope + space

**+ PROVIDING FREE DESIGN SERVICES
TO SUPPORT NEW PROJECTS AND FUNDING**



hope + space

+ DESIGNS THAT ARE NOT BUILT
MIGHT WORK WELL IN OTHER LOCATIONS

Certificate of Honor

BOARD OF SUPERVISORS
City and County of San Francisco

The Board of Supervisors of the City and County of San Francisco hereby issues, and authorizes the execution of, this Certificate of Honor in appreciative public recognition of distinction and merit for outstanding service to a significant portion of the people of the City and County of San Francisco by:

**DAVID FLETCHER AND
FLETCHER STUDIO**

In honor of your extraordinary leadership and outstanding community service, in working to improve the conditions of Angel Alley and beautifying our neighborhoods.

The City and County of San Francisco Board of Supervisors hereby extends their highest commendations and sends their best wishes to you on this special day.

Malin Cohen

SUPERVISOR MALIN COHEN
April 2, 2016



TERREFORM



CoDA
AWARDS
Collaboration of Design + Art



ARCHITECTURE PRESS RELEASE

RADA

hope+
space

award

+ JURIED "HOPE+SPACE AWARD"
ANNUALLY GIVEN TO BEST
PRO-BONO PROJECT

+ PORTAL CONNECTING
COMMUNITIES TO DESIGNERS



Harvard University
Graduate School of Design

FLETCHER STUDIO



21 OCTOBER 2020



THANK YOU

SAN LUIS OBISPO STATE